

EVO2

Air end



TECHNICAL SPECIFICATION

› Power range up to	11 kW / 15 HP
› Capacity up to	1.7 m ³ /min / 60 cfm
› Pressure up to	15 barg / 218 psig
› Weight approx.	15 kg / 33 lbs

››› Dimensioning

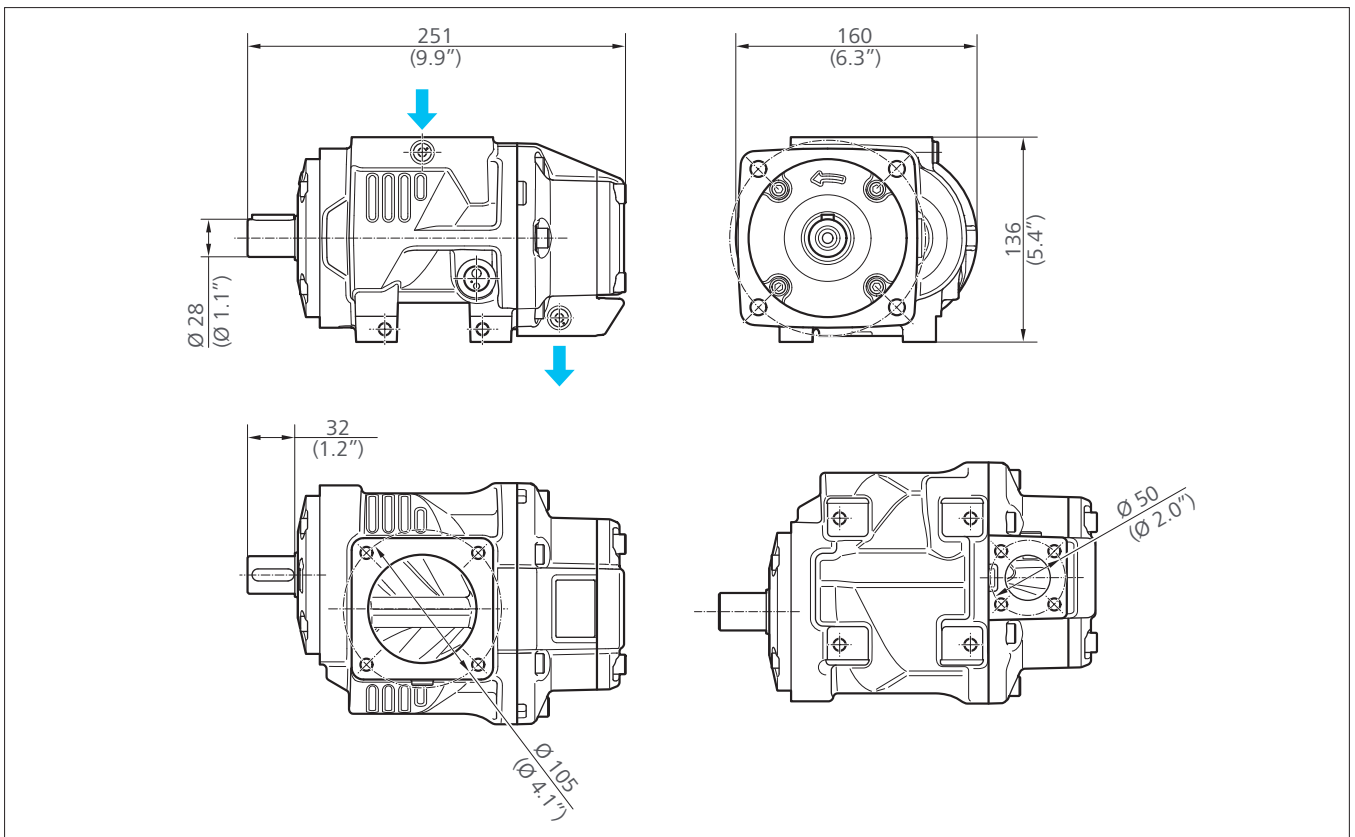

For detailed design, please order the installation drawing/3d model.

Technical modifications and errors excepted!
© 2010 ROTORCOMP®, Germany



Performance Data

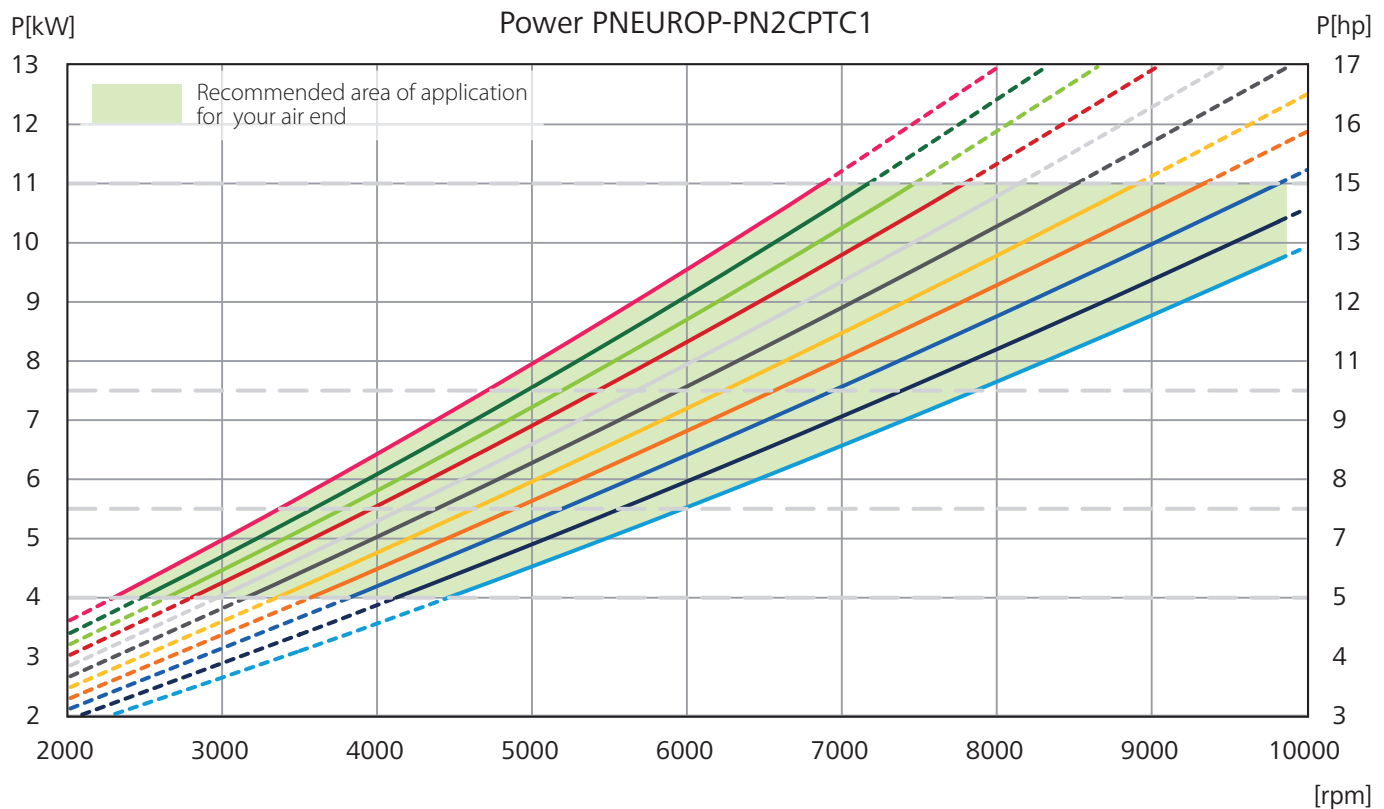
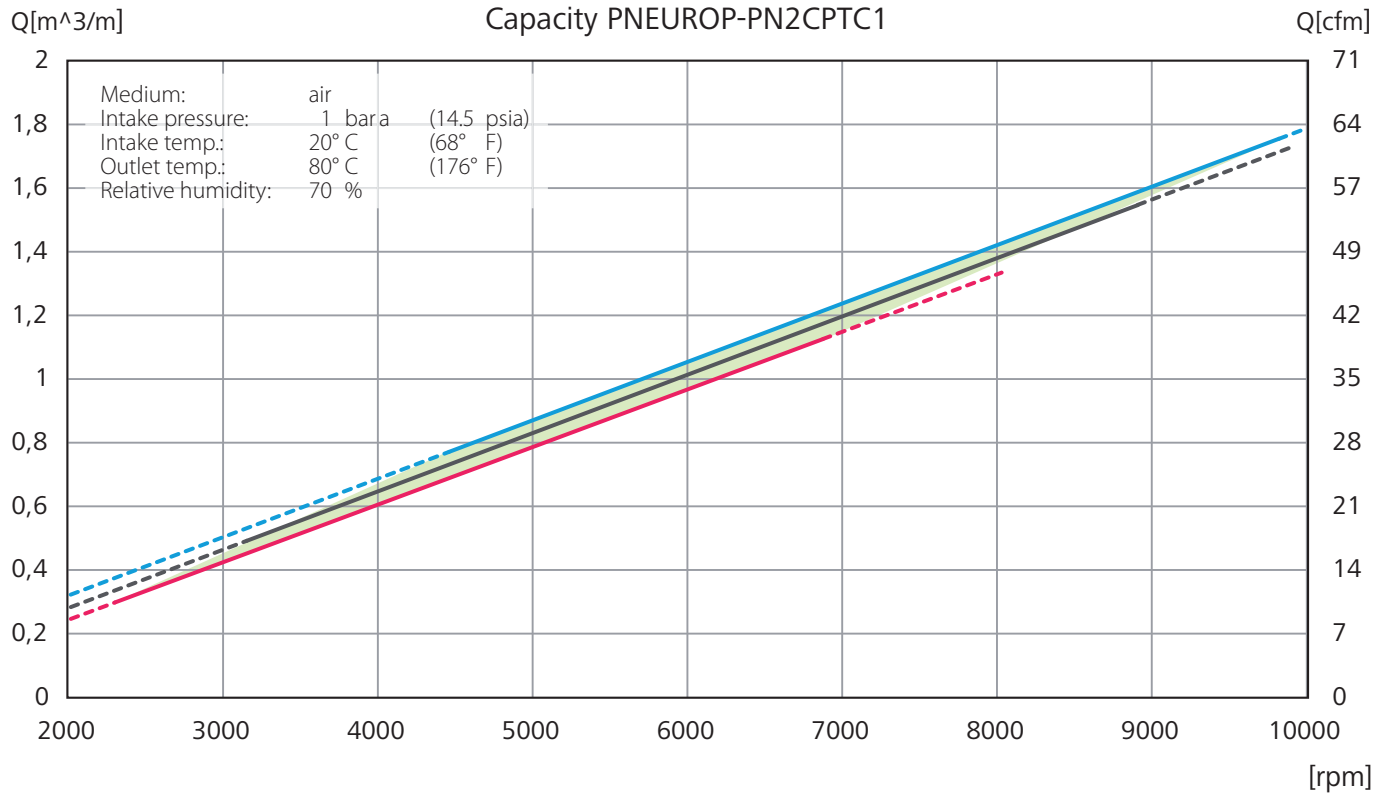

- — Typical motor characteristic lines
- | | | | | | | | | | | | |
|---------------------------------------|---|---------------------------------------|---|---|--|---|---------------------------------------|---|---|---|------|
| ■ 5 | ■ 6 | ■ 7 | ■ 8 | ■ 9 | ■ 10 | ■ 11 | ■ 12 | ■ 13 | ■ 14 | ■ 15 | barg |
| 73 | 87 | 102 | 116 | 131 | 145 | 160 | 174 | 189 | 203 | 218 | psig |

Technical modifications and errors excepted!
 © 2010 ROTORCOMP®, Germany

www.rotorcomp.de

EVO3

Air end



TECHNICAL SPECIFICATION

› Power range up to	18.5 kW / 25 HP
› Capacity up to	3.0 m ³ /min / 106 cfm
› Pressure up to	15 barg / 218 psig
› Weight approx.	21 kg / 46 lbs

››› Dimensioning

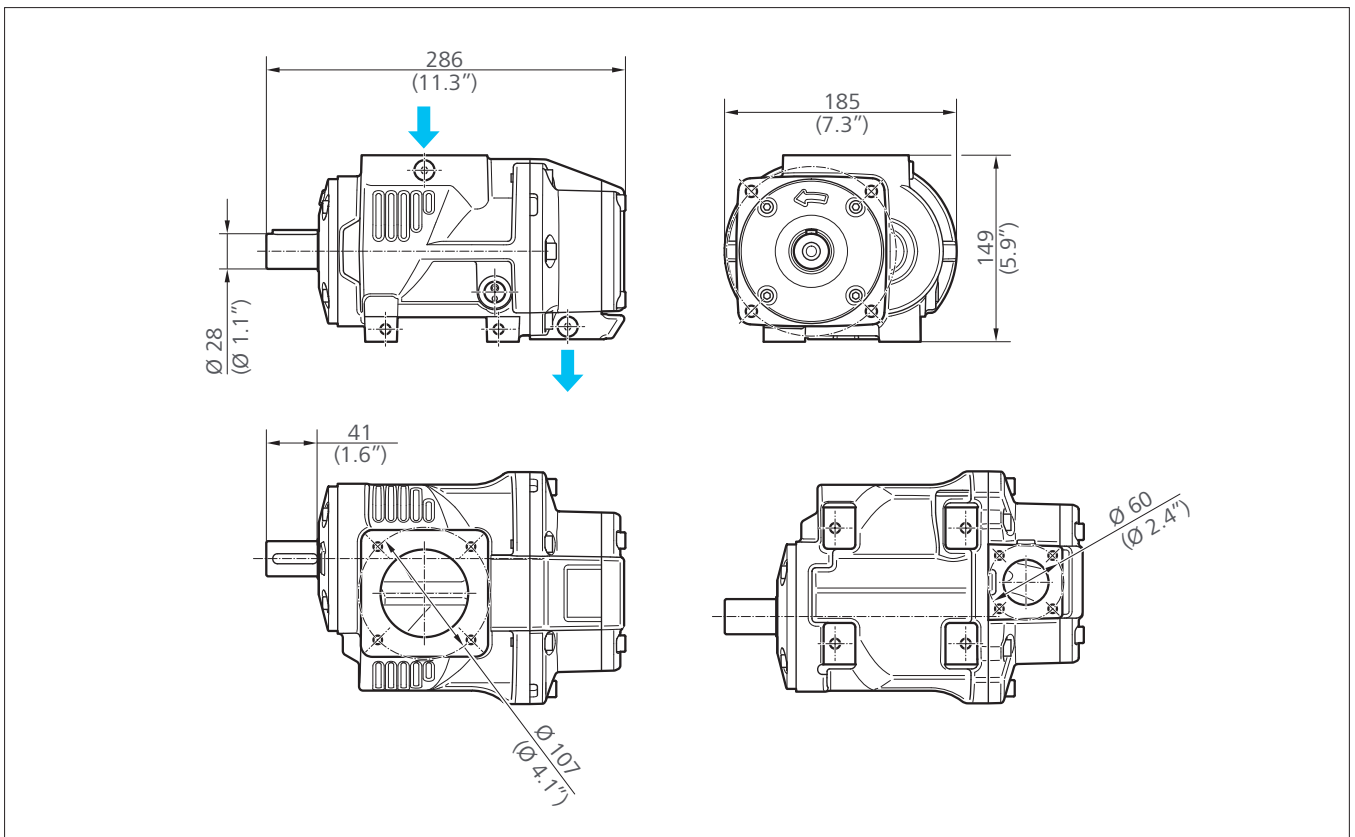

For detailed design, please order the installation drawing/3d model.

Technical modifications and errors excepted!
© 2010 ROTORCOMP®, Germany



Performance Data

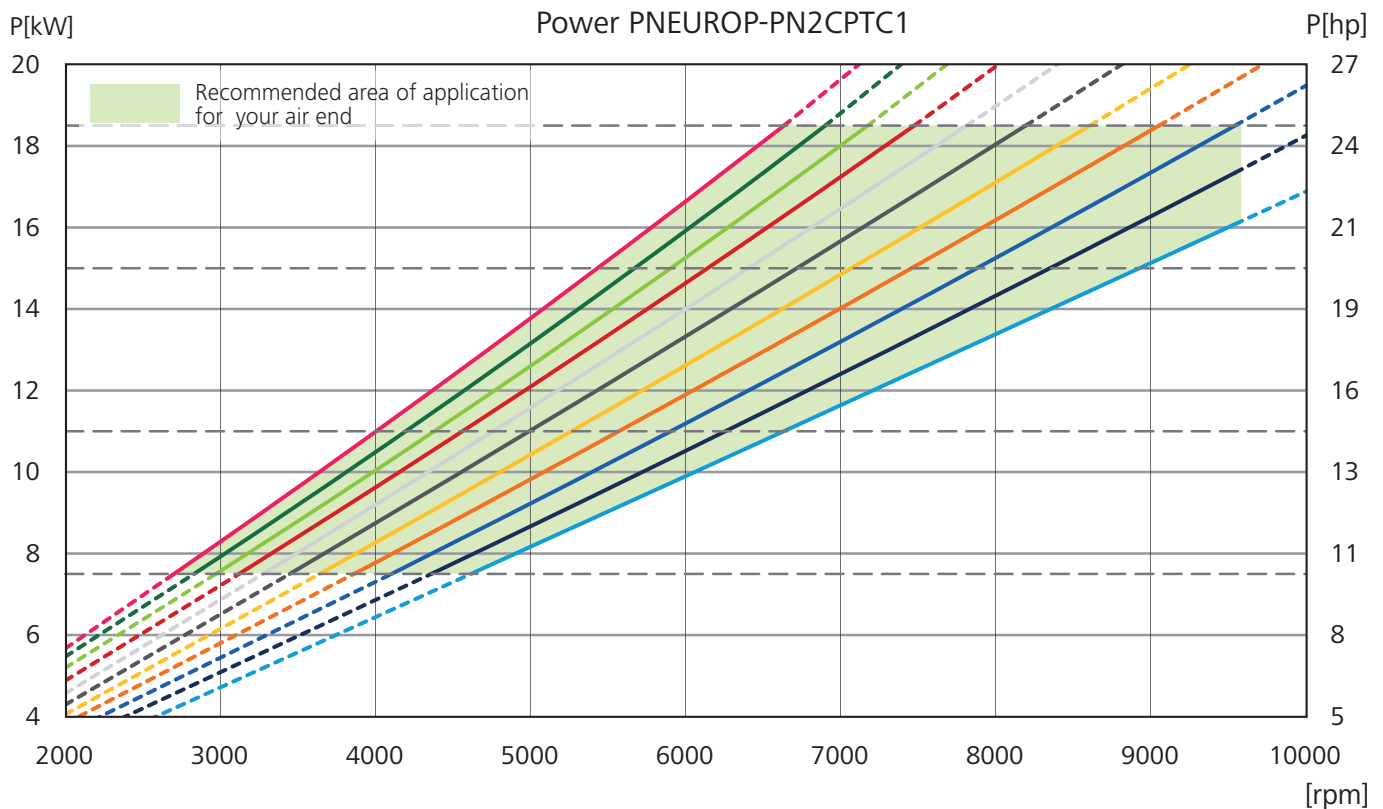
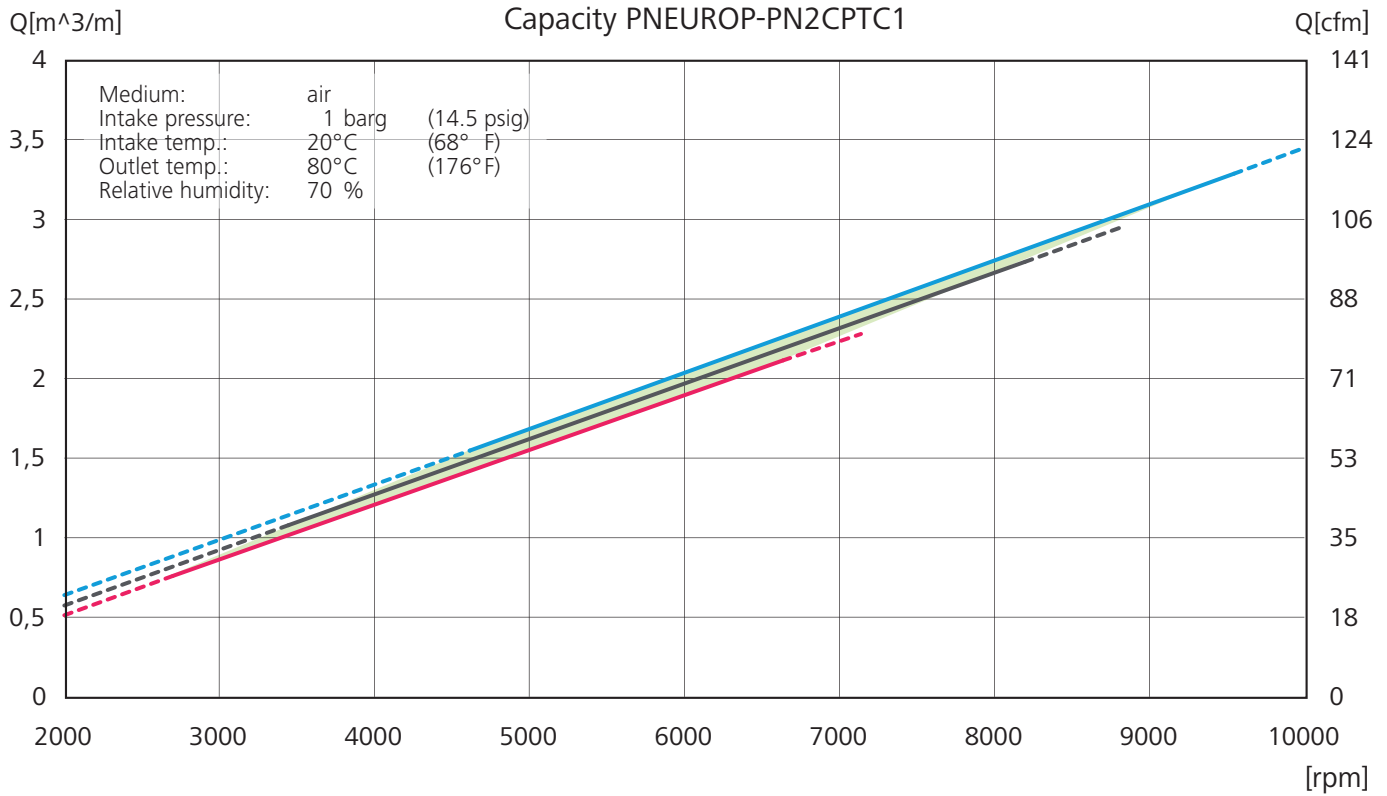

— Typical motor characteristic lines

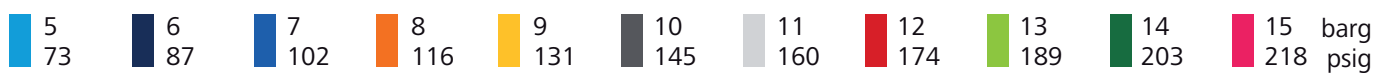

Technical modifications and errors excepted!
 © 2010 ROTORCOMP®, Germany

www.rotorcomp.de

Air end B 101

The ROTORCOMP B 101 screw compressor air end is an oil-injected rotary compressor. ROTORCOMP rotary compressors are suitable for all driving motors. Belt transmission, direct drive and gearbox options are available as required.

The wear-free ROLLING PROFIL® and the generously dimensioned sub-assemblies guarantee a long service life. Complemented with components from the ROTORCOMP programme it forms a perfectly coordinated compressor unit.

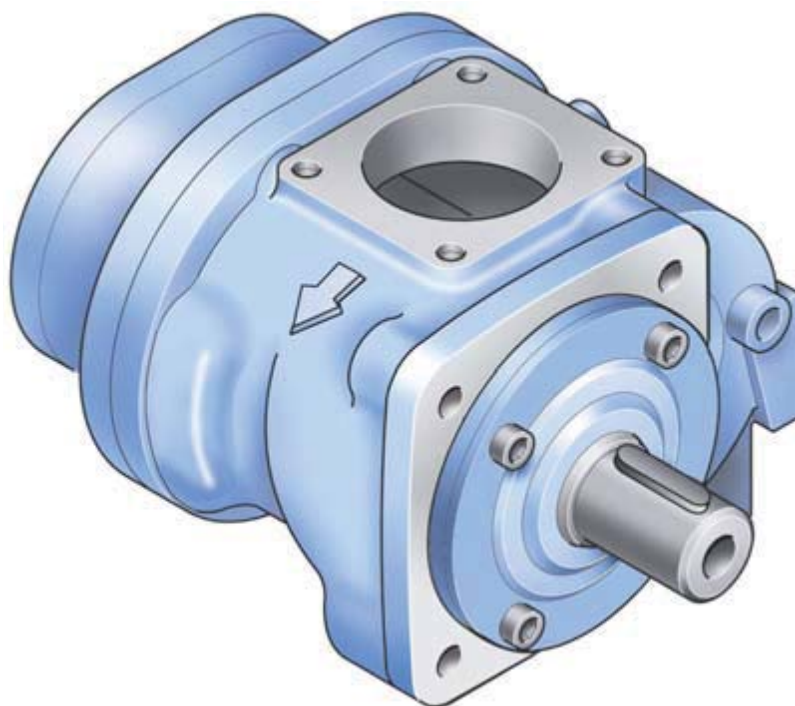

Operating range	
Power range up to	30* kW
Capacity up to	4.3 m ³ /min
Pressure up to	15 bar g
Weight approx.	30 kg

*Higher shaft power on request.

B 101

Dimensional details

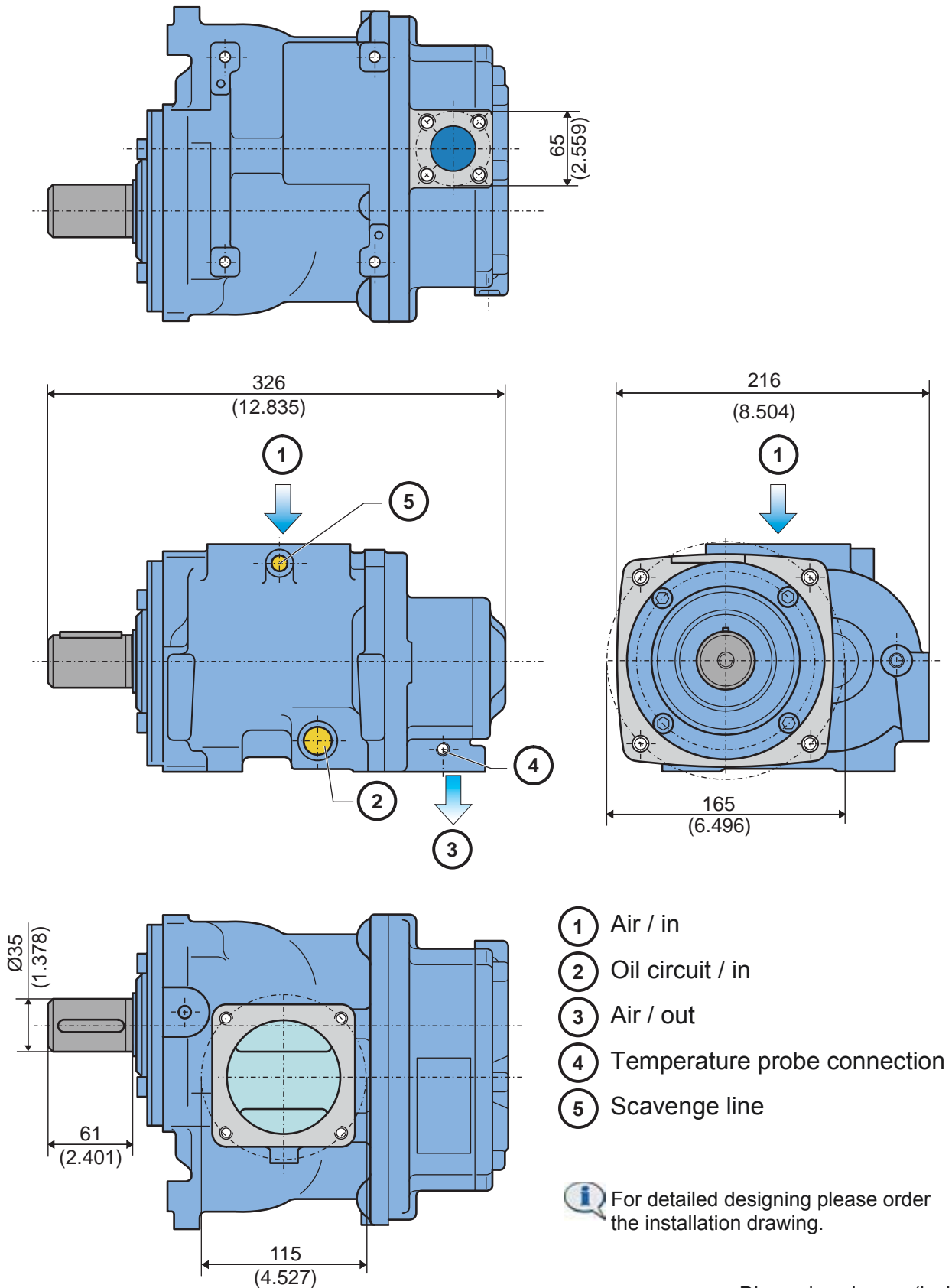

Dimensions in mm (inch)

B 101

Performance data

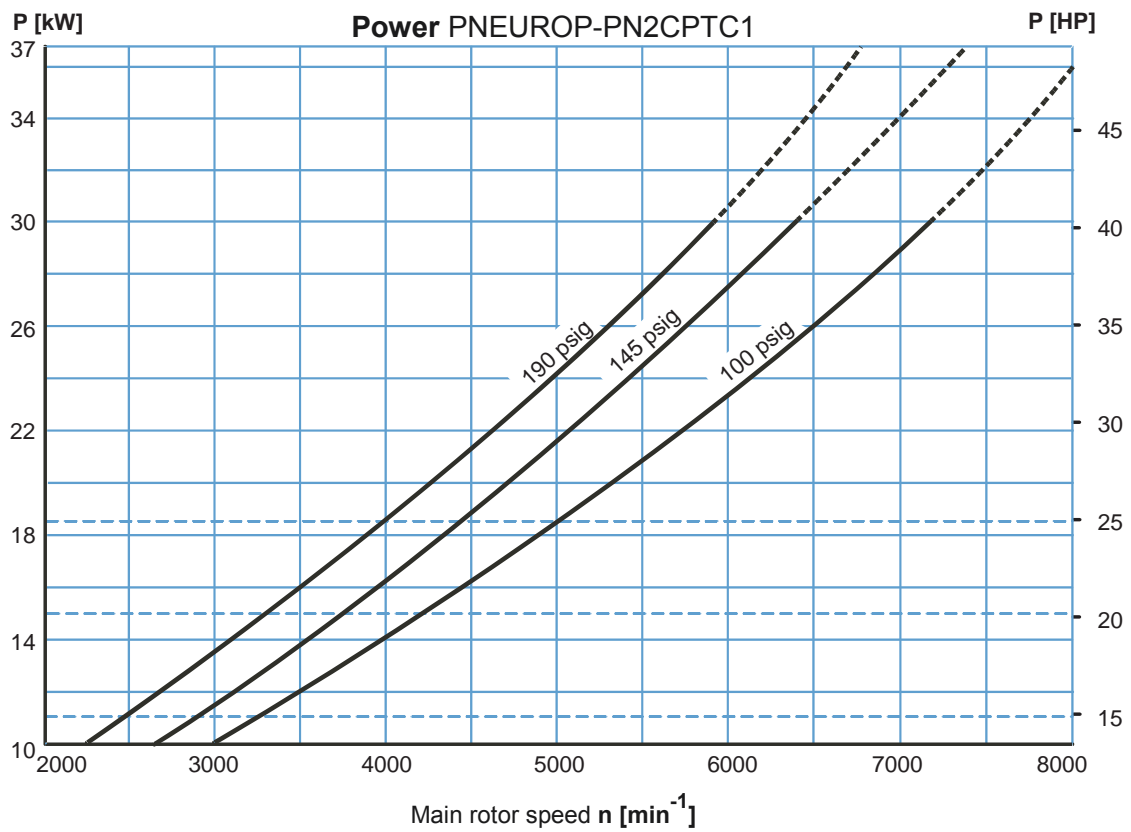
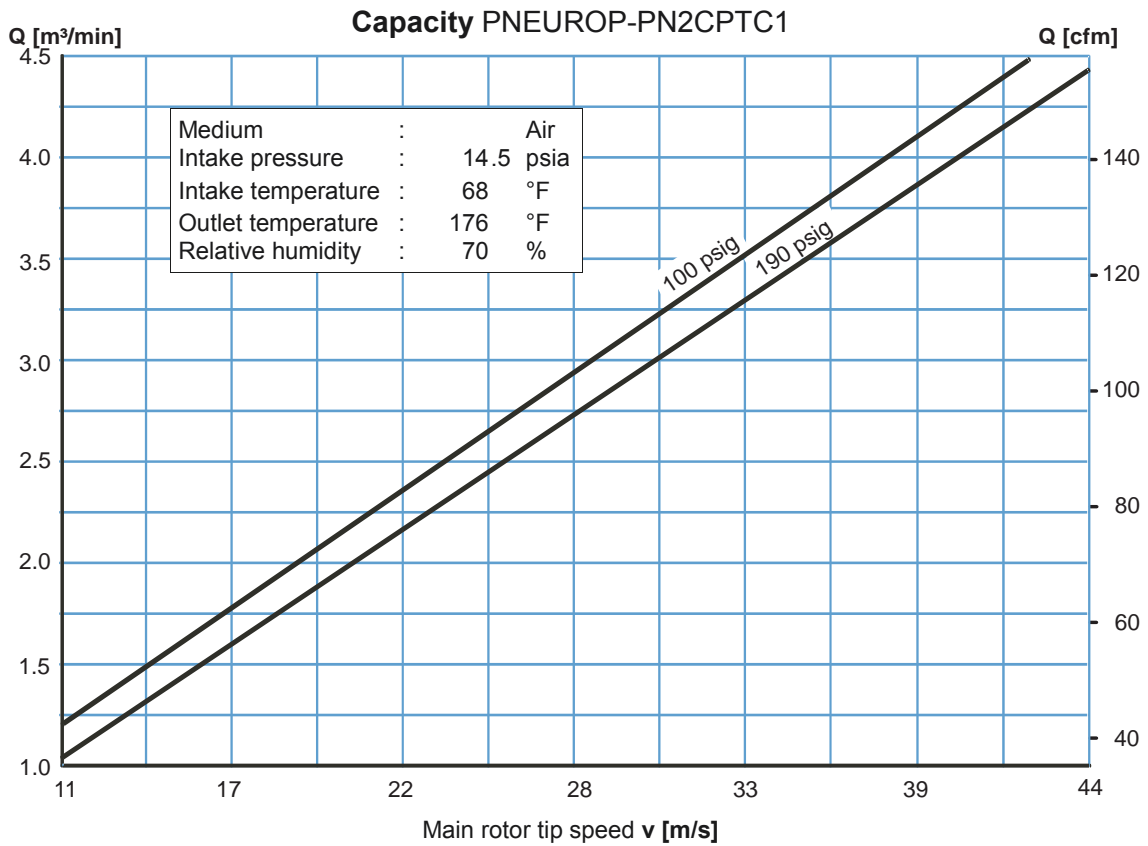

B 101

Components

Recommended original ROTORCOMP-equipment

	<p>Safety Combistat</p>		<p>Control unit</p>
	<p>Fan (A) (Rotation direction /right) (Rotation direction / left) Oil cooler / Air after cooler (B)</p>		<p>Oil thermostats / Oil filters</p>
	<p>Intake filters Intake controls</p>		<p>Maintenance indicator (for intake filter) (A)= optical (B)= electrical</p>
	<p>Safety pressure switches</p>		<p>Glycerine pressure gauge</p>
	<p>Separator cartridges / Separator heads</p>		<p>Special tools</p>

EVO 6

Air end



TECHNICAL SPECIFICATION

- › Power range up to 37 kW / 50 HP
- › Capacity up to 6.0 m³/min / 212 cfm
- › Pressure up to 15 barg / 218 psig
- › Weight approx. 45 kg / 99 lbs

››› Dimensioning

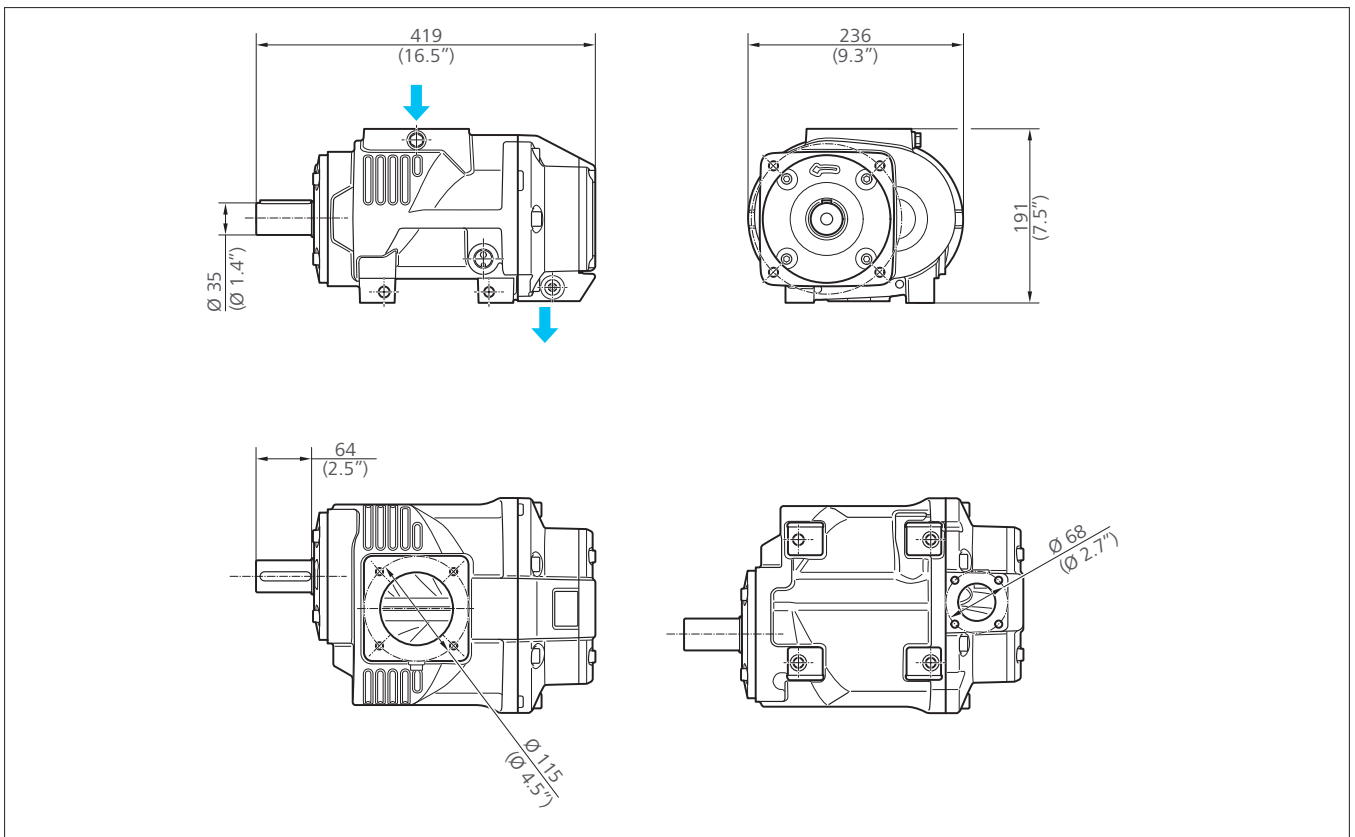

For detailed design, please order the installation drawing/3d model.

Technical modifications and errors excepted!
© 2010 ROTORCOMP®, Germany



Performance Data

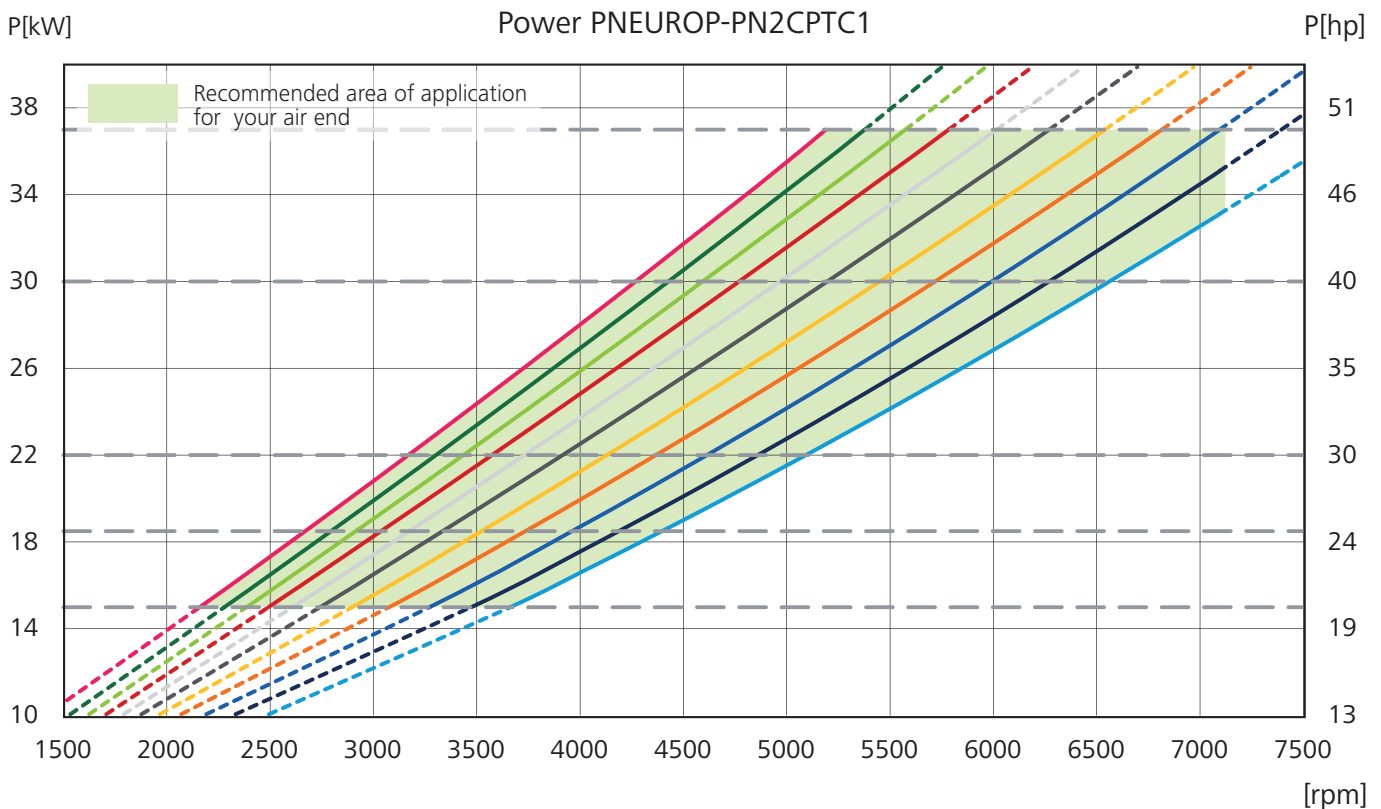
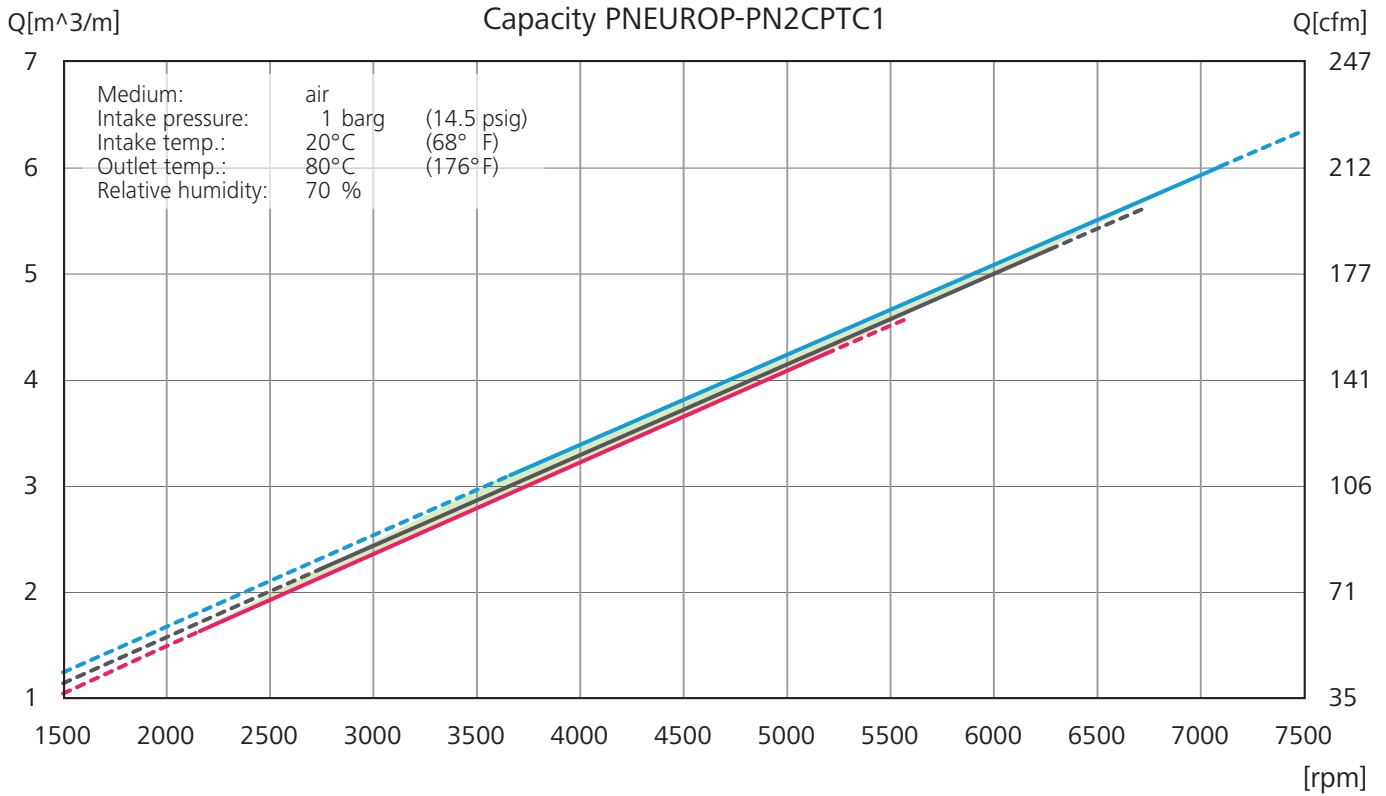

— Typical motor characteristic lines

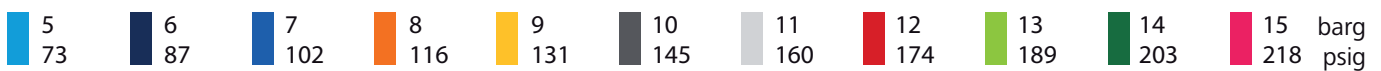

Technical modifications and errors excepted!
 © 2010 ROTORCOMP®, Germany

Air end B 101 G

The ROTORCOMP B 101 screw compressor air end B 101 G consists of stage B 101 and the front-end flanged-on transmission gearing.

B 101 G - Air End is for the installation in rotary screw compressor systems, stationary or mobile, with electric motor or combustion engine drive conceived.

B 101 G horizontal

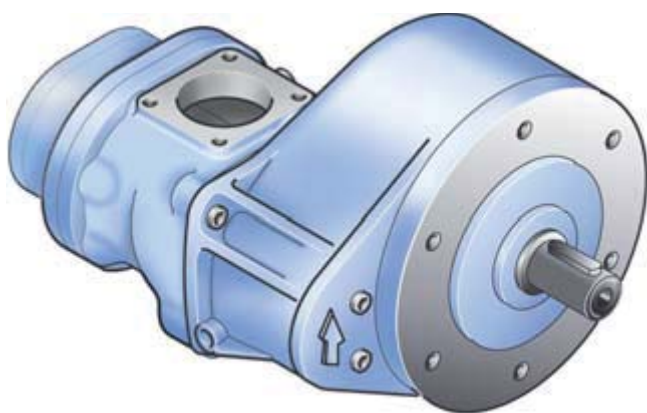

B 101 G vertical

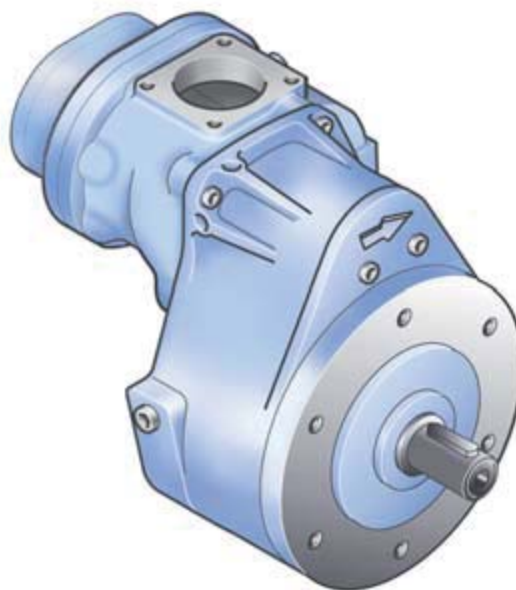

Operating range

Power range up to.....	30* kW
Capacity up to	4.3 m ³ /min
Pressure up to.....	15 bar g
Weight approx.	54 kg

*Higher shaft power on request.

B 101 G

Dimensional details

B 101 G horizontal

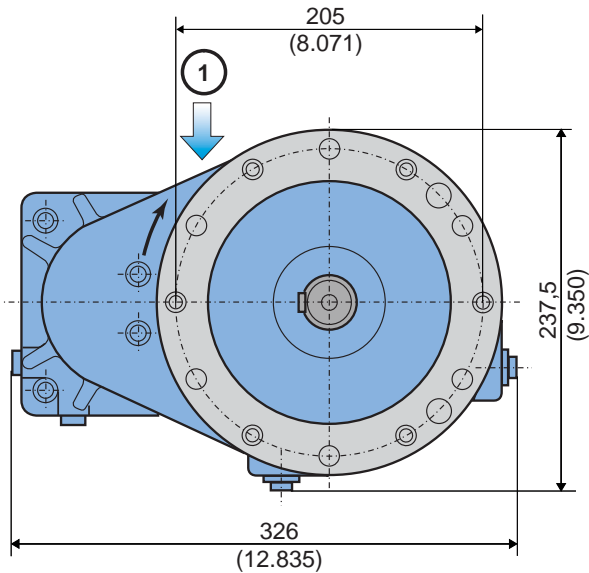

B 101 G vertical

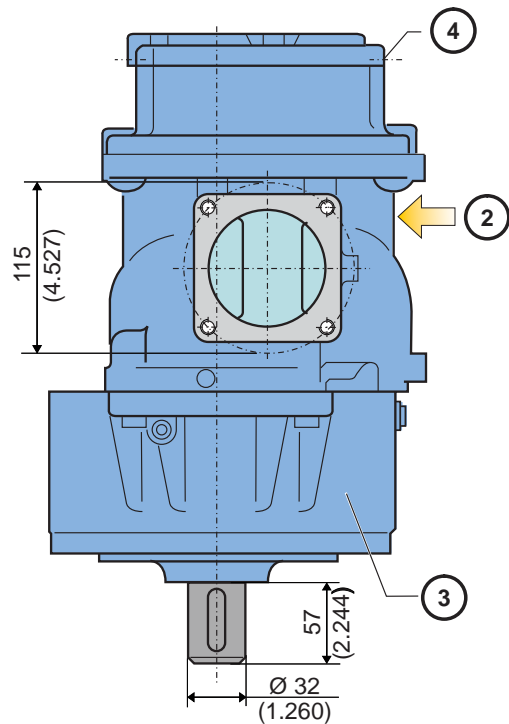
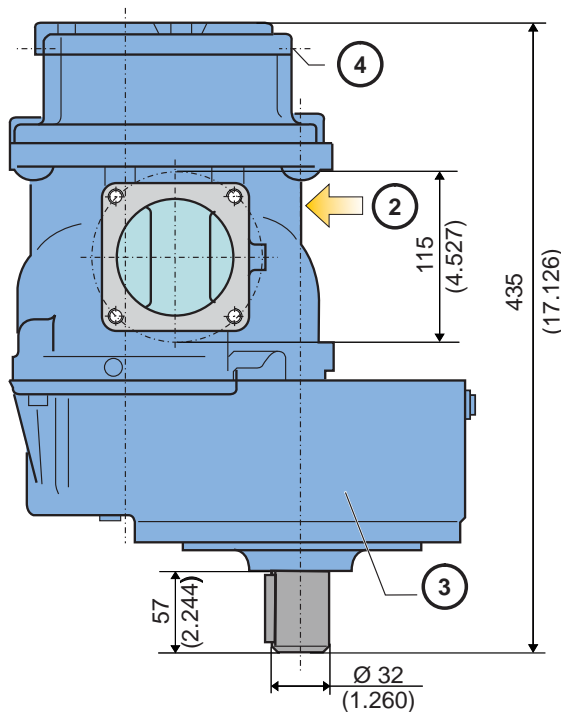
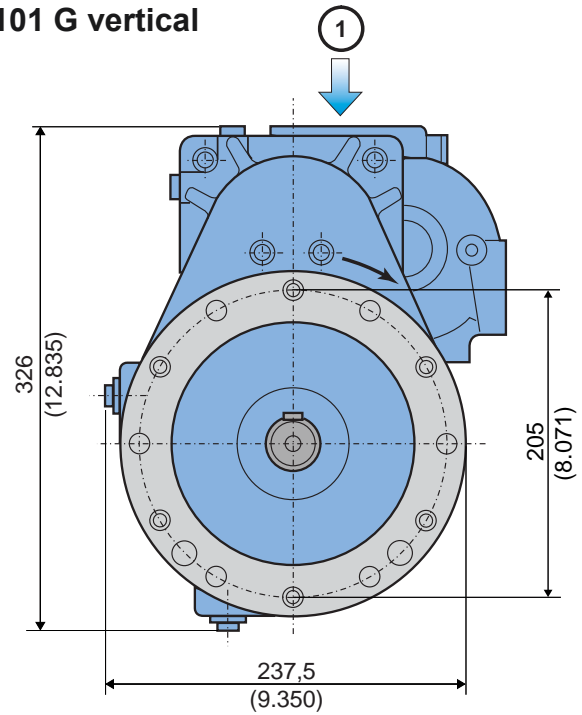

- 1 Air / in
- 2 Oil circuit / in
- 3 Gear
- 4 Temperature probe connection

 For detailed designing please order the installation drawing.

Dimensions in mm (inch)

B 101 G

Performance data

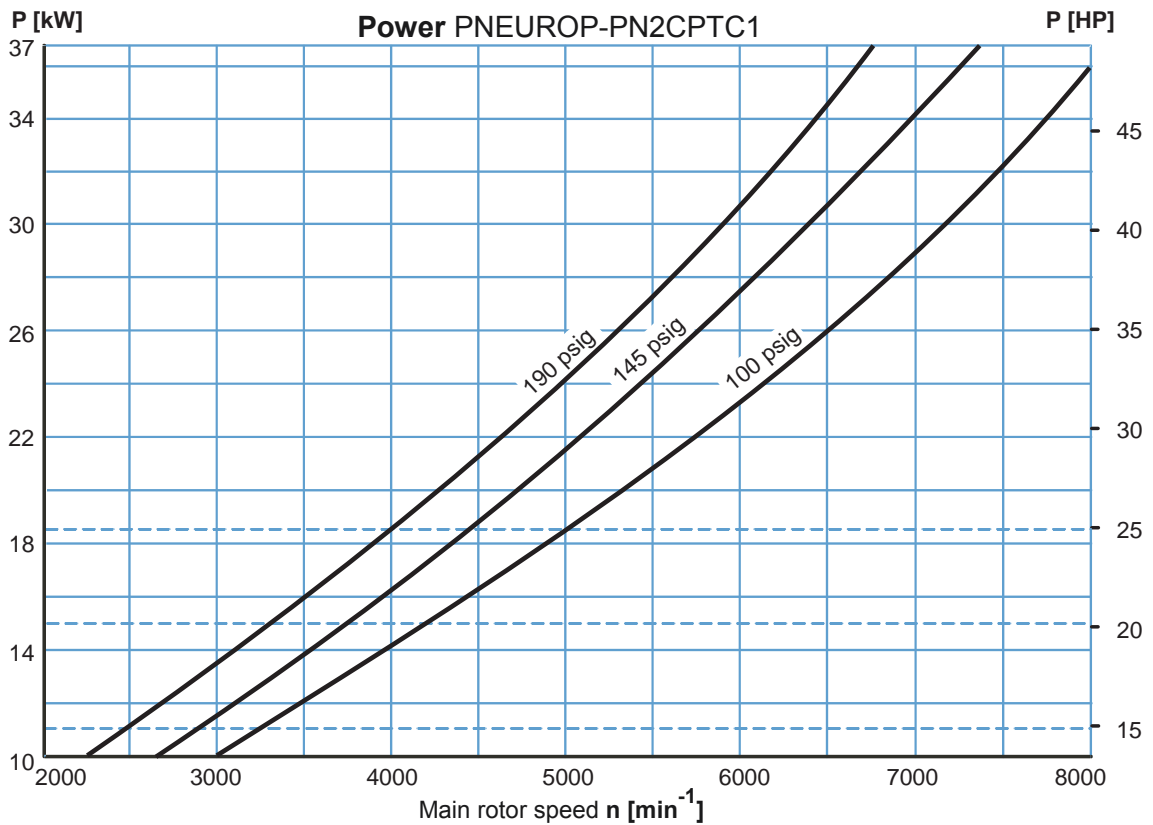
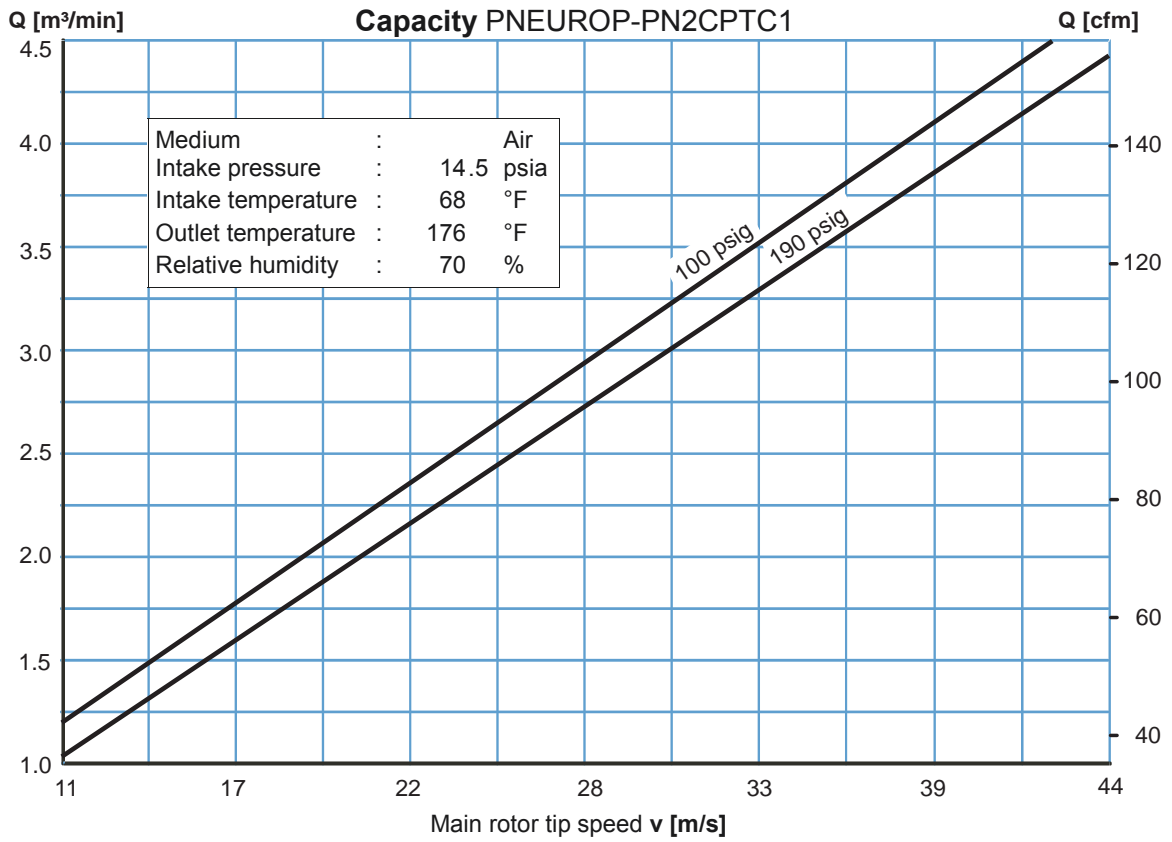

B 101 G

Performance data

Driver speed

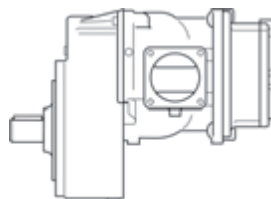

Air end speed

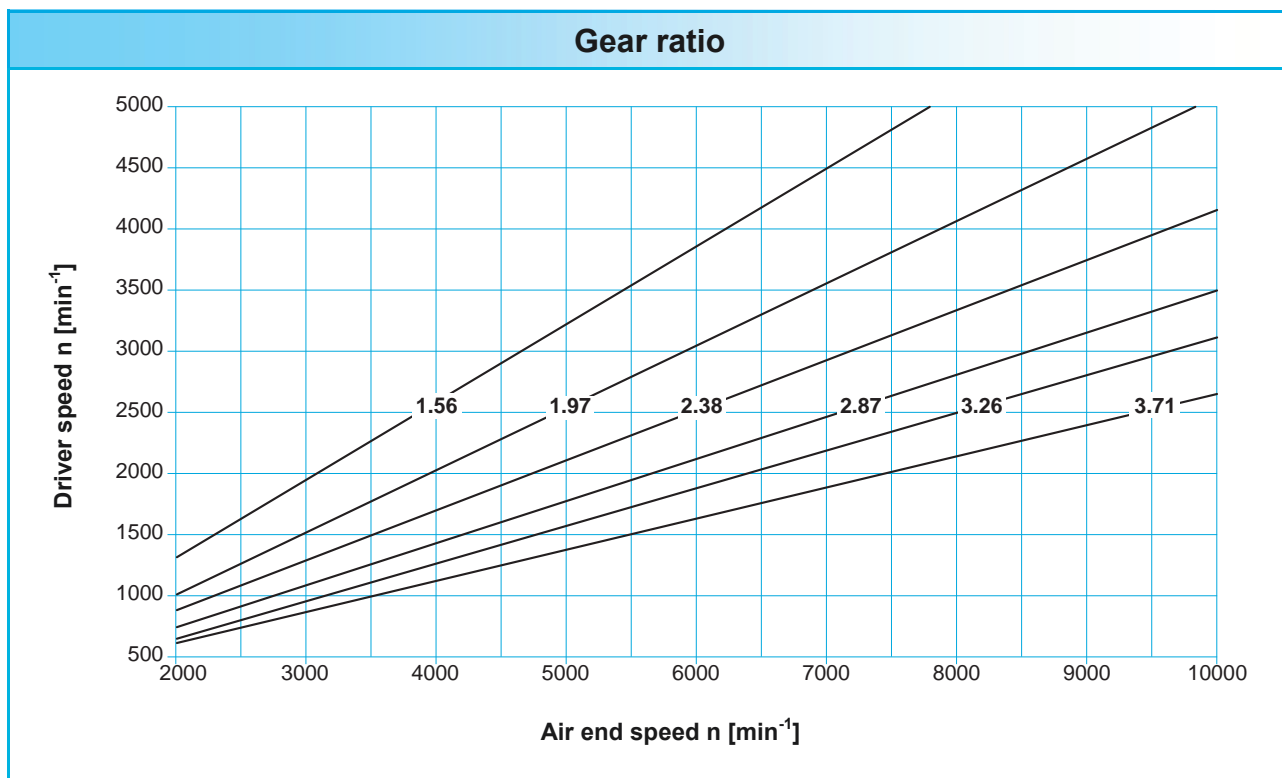

Additional order information		
Transmission ratio entrance / exit		Resulting transmission ratio
70 / 45		1,56
72 / 43	not illustrated	1,67
77 / 39		1,97
81 / 34		2,38
86 / 29	not illustrated	2,97
86 / 30		2,87
88 / 26	not illustrated	3,38
88 / 27		3,26
104 / 28		3,71

EVO9

Air end



TECHNICAL SPECIFICATION

› Power range up to	55 kW / 75 HP
› Capacity up to	8.8 m ³ /min / 311 cfm
› Pressure up to	15 barg / 218 psig
› Weight approx.	68 kg / 150 lbs

››› Dimensioning

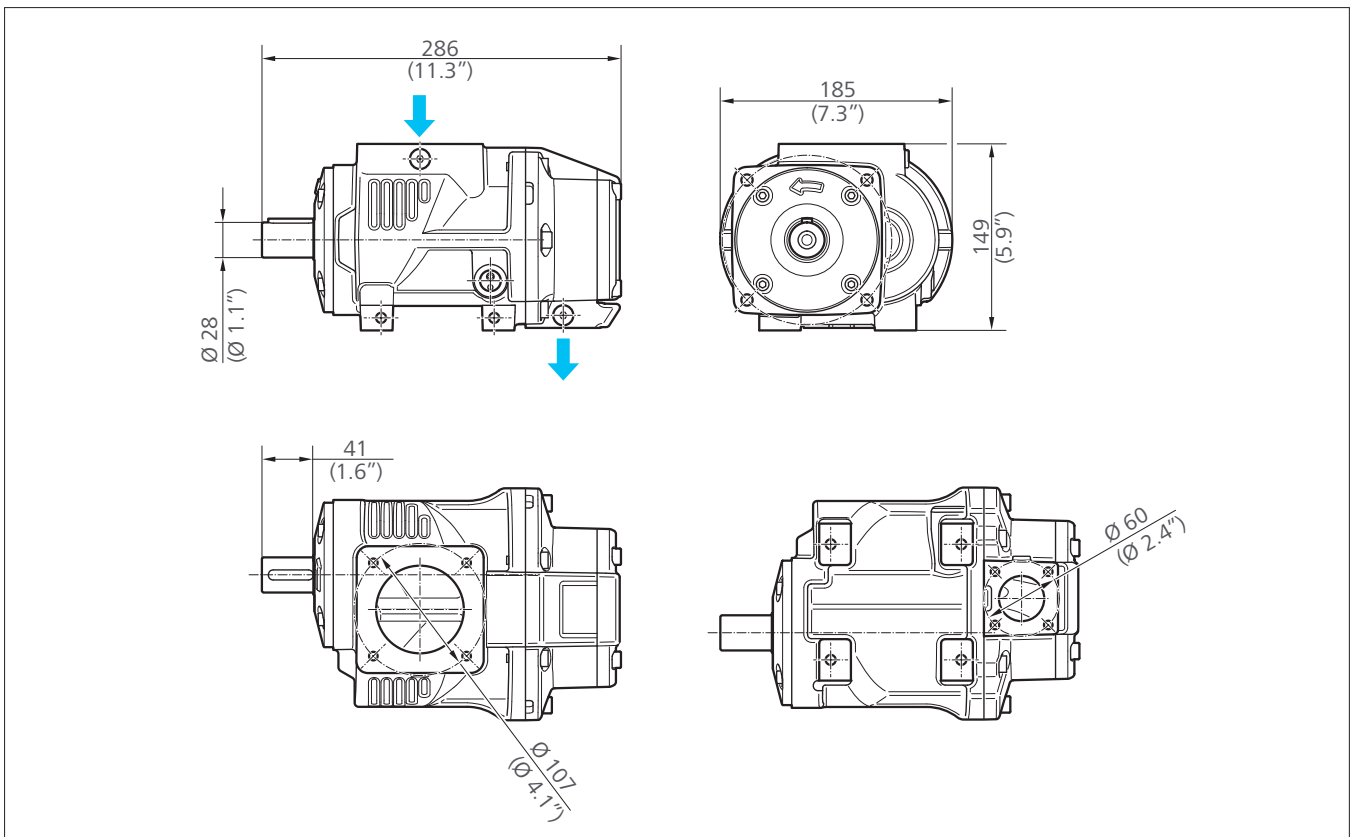

For detailed design, please order the installation drawing/3d model.

Technical modifications and errors excepted!
© 2010 ROTORCOMP®, Germany



Performance Data

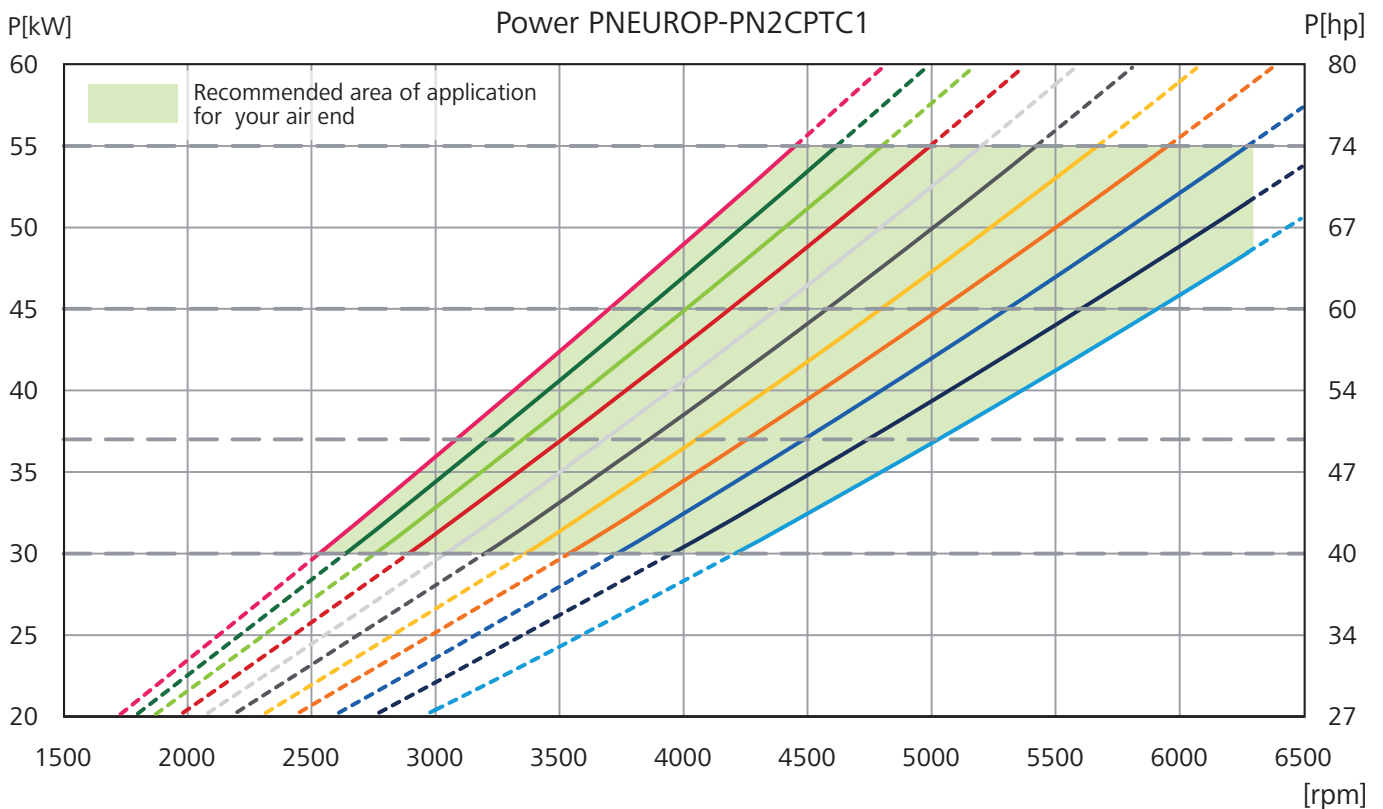
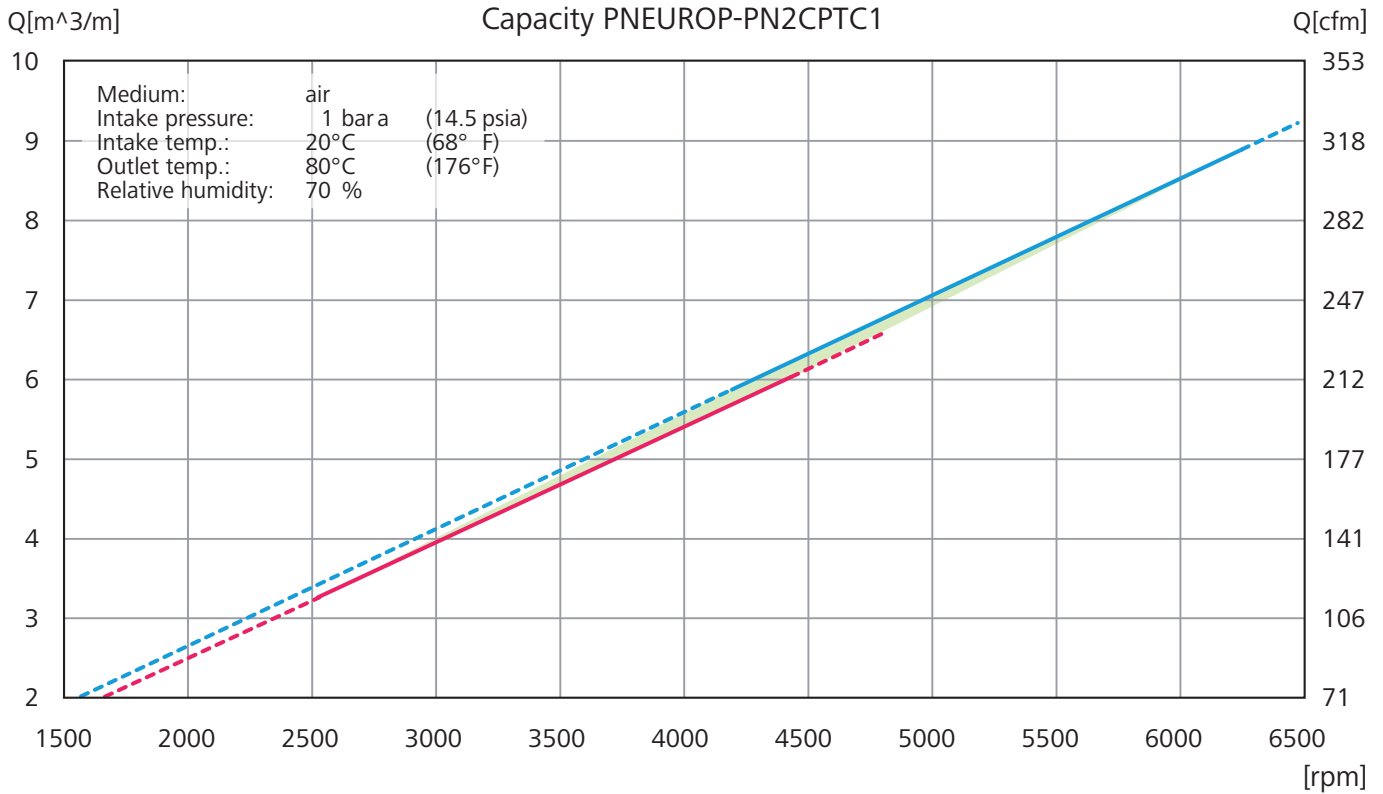

— Typical motor characteristic lines

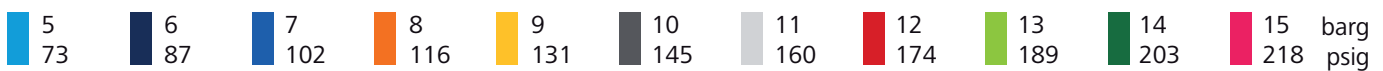

Technical modifications and errors excepted!
 © 2010 ROTORCOMP®, Germany

www.rotorcomp.de

Air end B 201

The ROTORCOMP B 201 screw compressor air end is an oil-injected rotary compressor. ROTORCOMP rotary compressors are suitable for all driving motors. Belt transmission, direct drive and gearbox options are available as required.

The wear-free ROLLING PROFIL® and the generously dimensioned sub-assemblies guarantee a long service life. Complemented with components from the ROTORCOMP programme it forms a perfectly coordinated compressor unit.

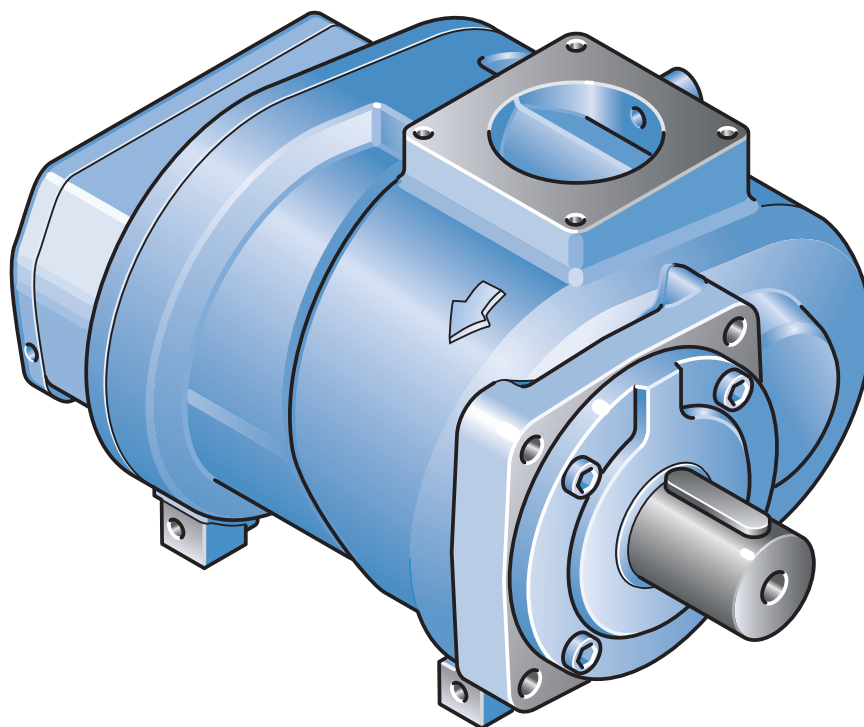



Operating range	
Power range up to	90* kW
Capacity up to	14.2 m ³ /min
Pressure up to	15 bar g
Weight approx.	113 kg

*Higher shaft power on request.

B 201

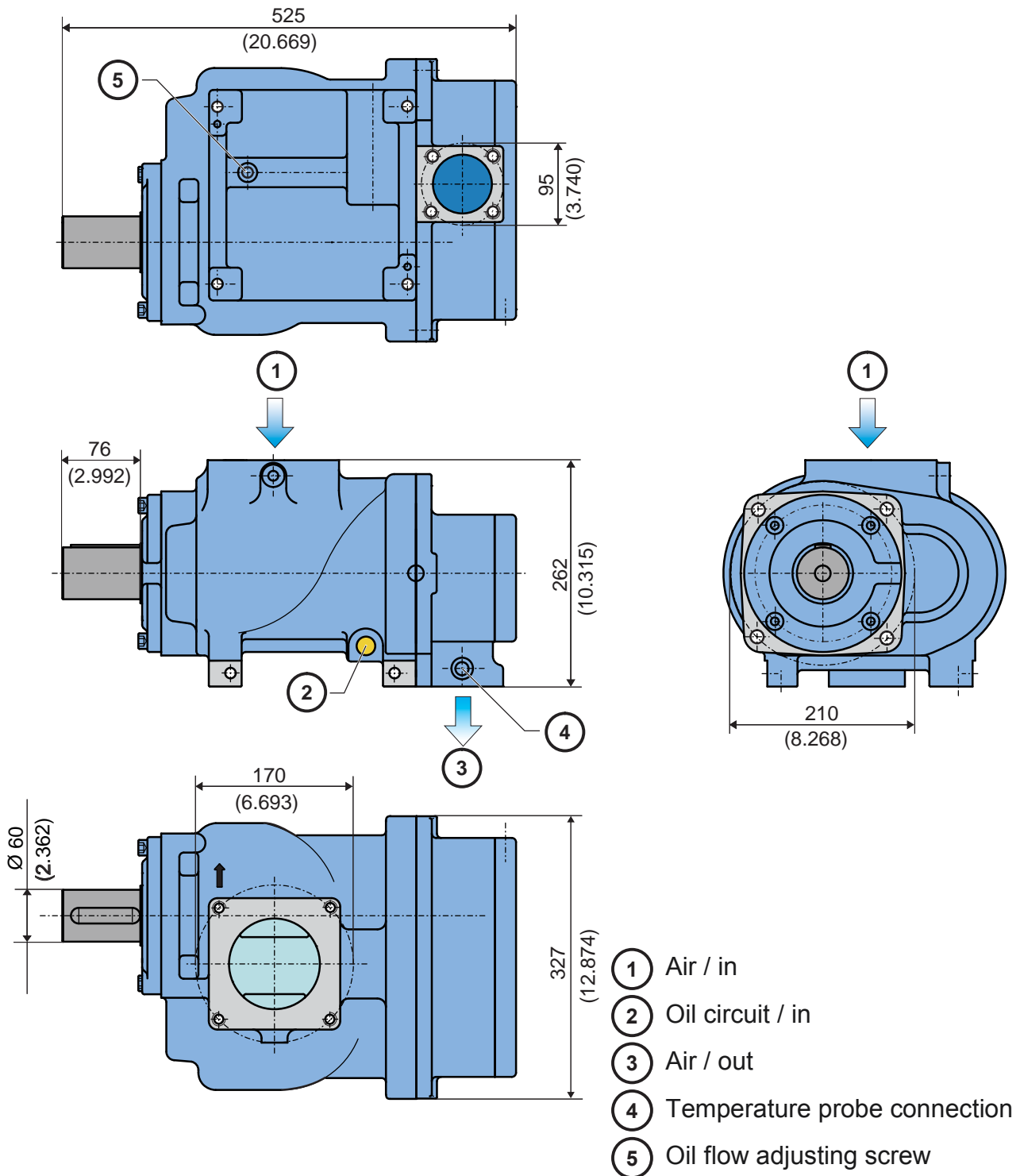
Dimensional details



 For detailed designing please order the installation drawing.

Dimensions in mm (inch)

B 201

Performance data

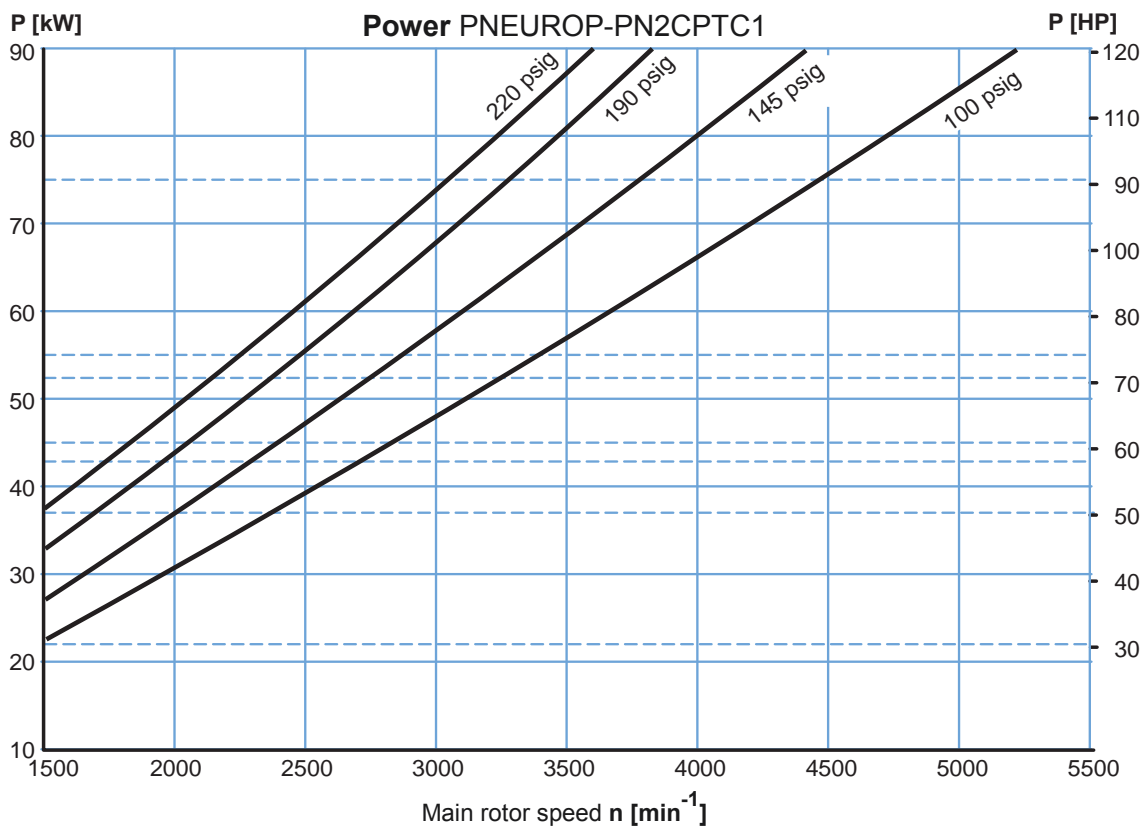
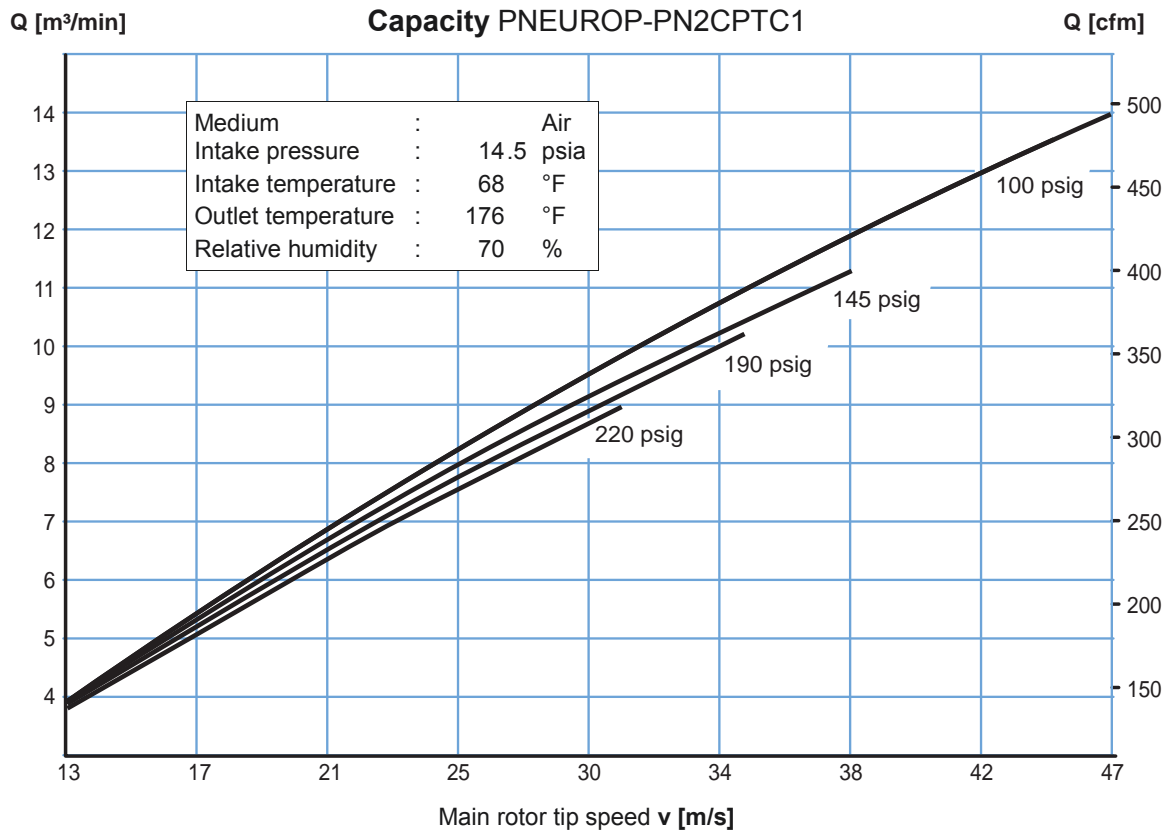

B 201

Components

Recommended original ROTORCOMP-equipment

	<p>Safety Combistat</p>		<p>Control unit</p>
	<p>Fan (A) (Rotation direction /right) (Rotation direction / left) Oil cooler / Air after cooler (B)</p>		<p>Oil thermostats / Oil filters</p>
	<p>Intake filters Intake controls</p>		<p>Maintenance indicator (for intake filter) (A)= optical (B)= electrical</p>
	<p>Safety pressure switches</p>		<p>Glycerine pressure gauge</p>
	<p>Separator cartridges / Separator heads</p>		<p>Special tools</p>

Air end B 201 G

The ROTORCOMP B 201 screw compressor air end B 201 G consists of stage B 201 and the front-end flanged-on transmission gearing.

B 201 G - Air End is for the installation in rotary screw compressor systems, stationary or mobile, with electric motor or combustion engine drive conceived.

B 201 G horizontal

B 201 G vertical

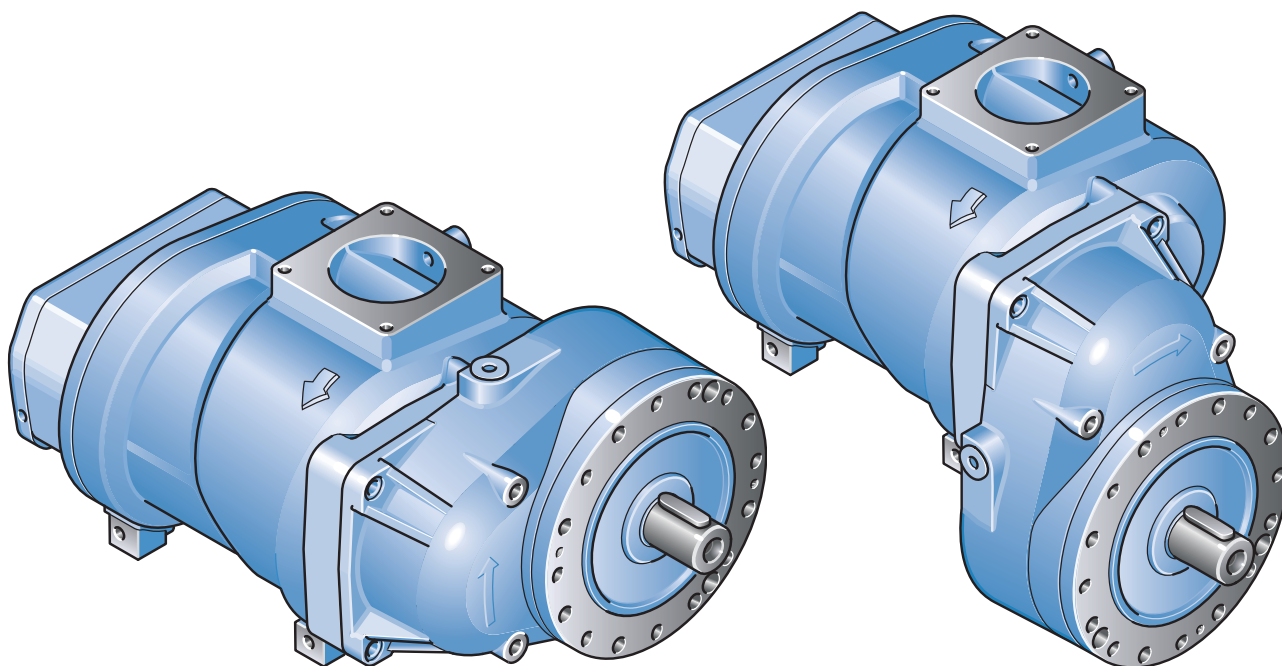

Operating range

Power range up to	90* kW
Capacity up to	14.2 m ³ /min
Pressure up to	15 bar g
Weight approx.	156 kg

*Higher shaft power on request.

B 201 G

Dimensional details

B 201 G horizontal

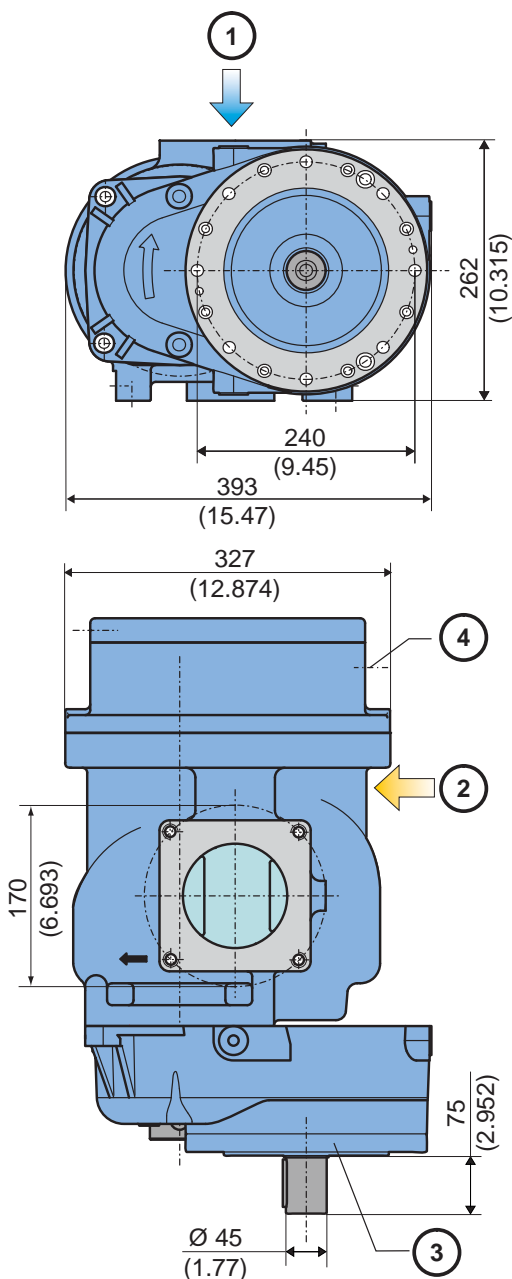

B 201 G vertical

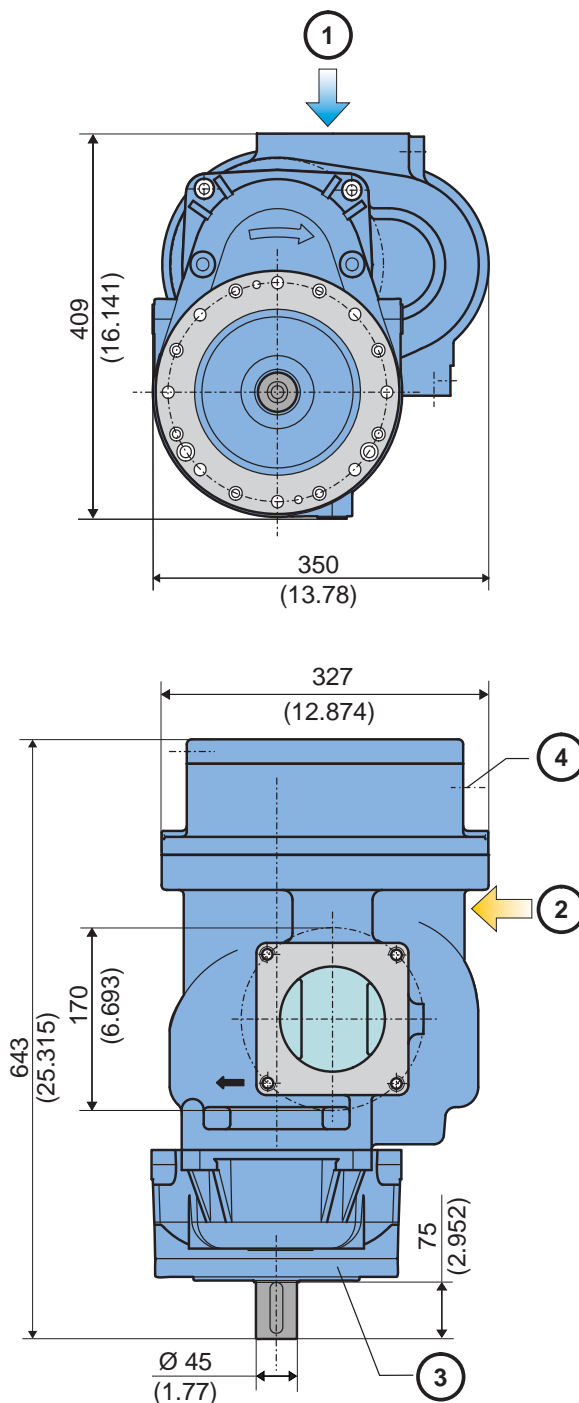

- ① Air / in
- ② Oil circuit / in
- ③ Gear
- ④ Temperature probe connection

 For detailed designing please order the installation drawing.

Dimensions in mm (inch)

B 201 G

Performance data

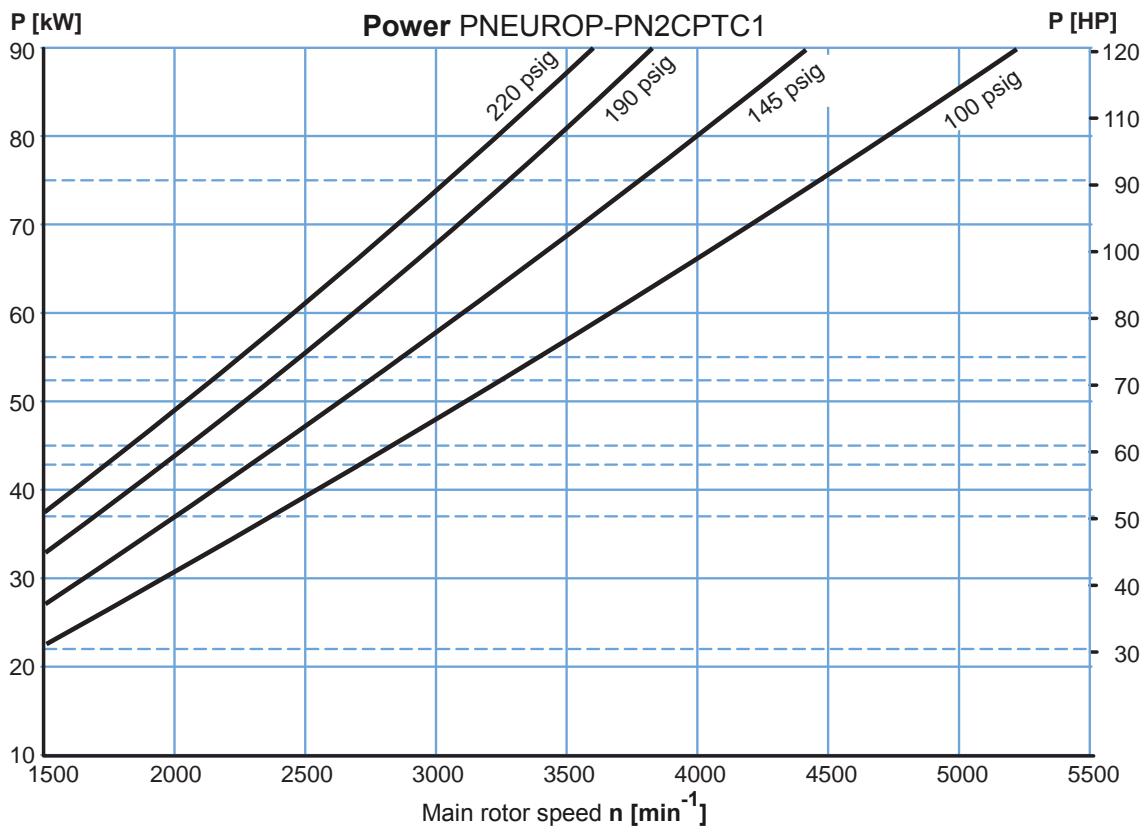
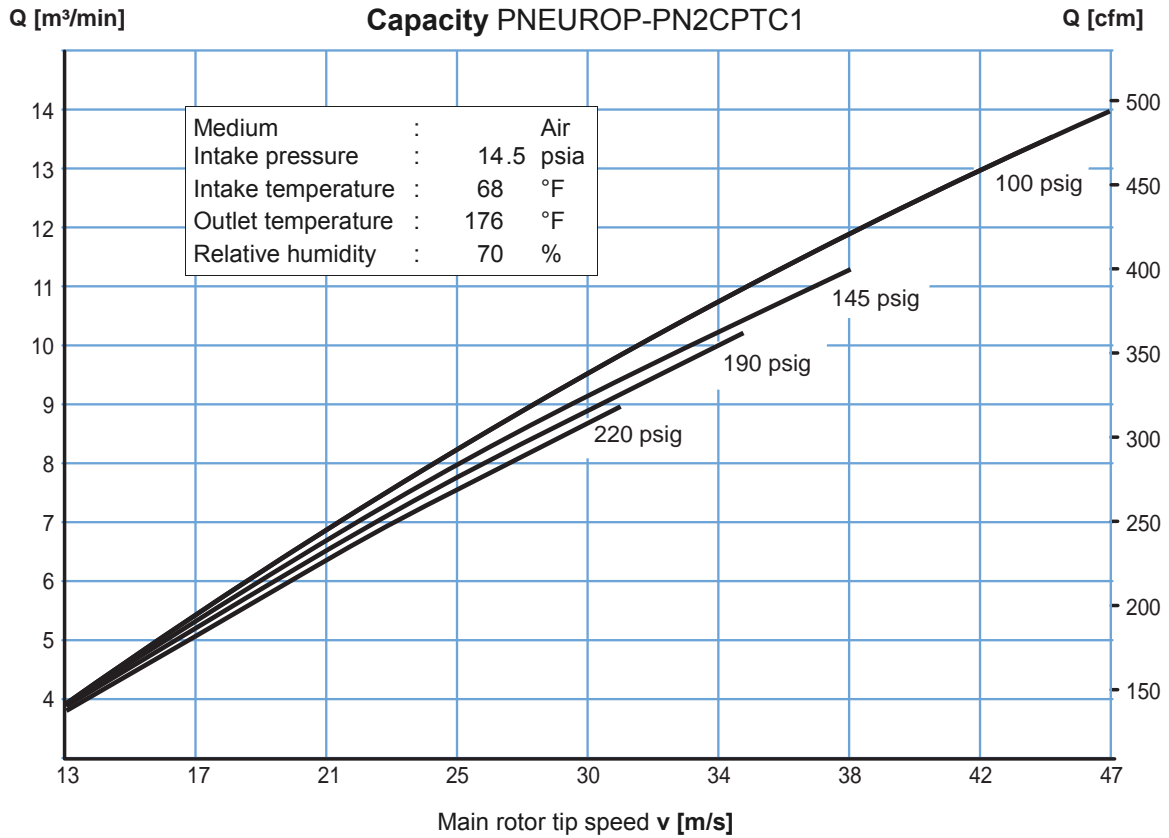

B 201 G

Performance data

Driver speed

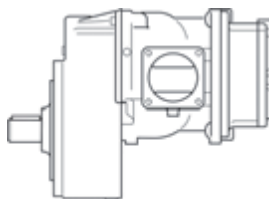

Air end speed

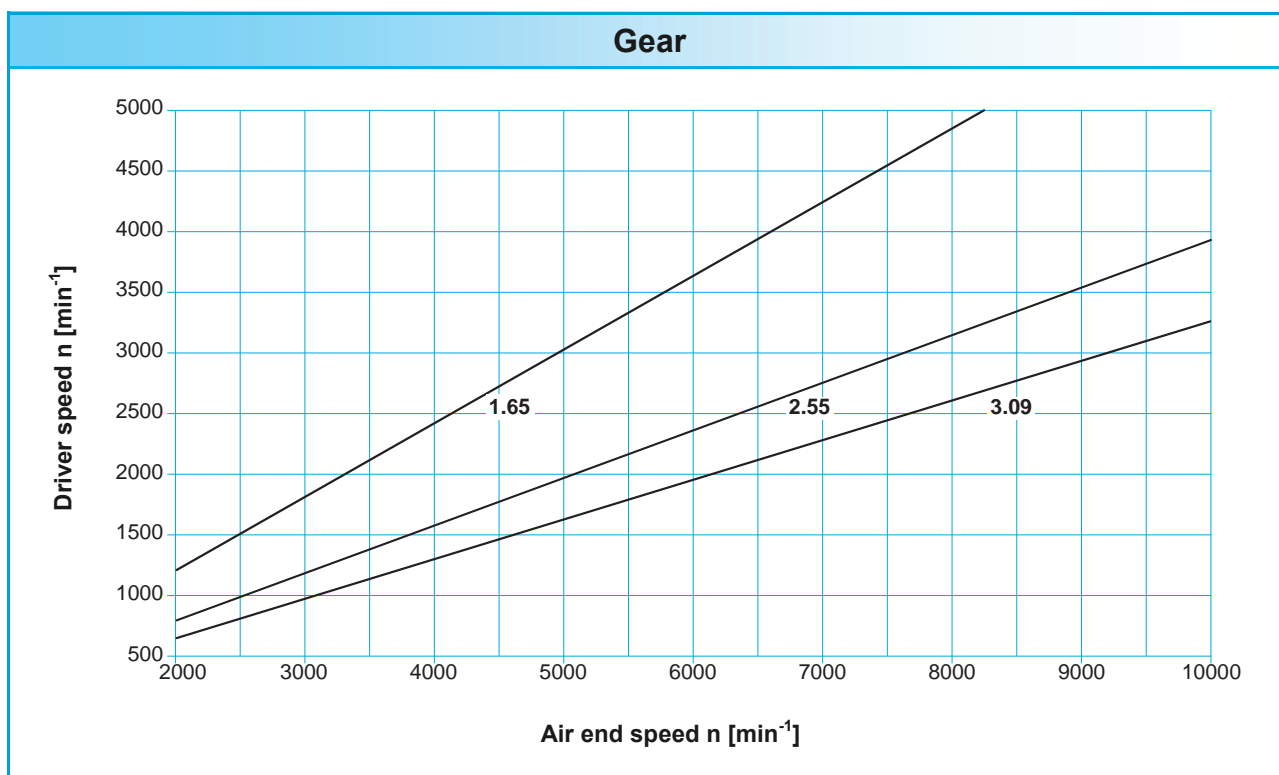

Additional order information	
Transmission ratio entrance / exit	Resulting transmission ratio
84 / 51	1.65
97 / 38	2.55
102 / 33	3.09

Air end B 260

The ROTORCOMP B 260 screw compressor air end is an oil-injected rotary compressor. ROTORCOMP rotary compressors are suitable for all driving motors. Belt transmission, direct drive and gearbox options are available as required.

The wear-free ROLLING PROFIL® and the generously dimensioned sub-assemblies guarantee a long service life. Complemented with components from the ROTORCOMP programme it forms a perfectly coordinated compressor unit.

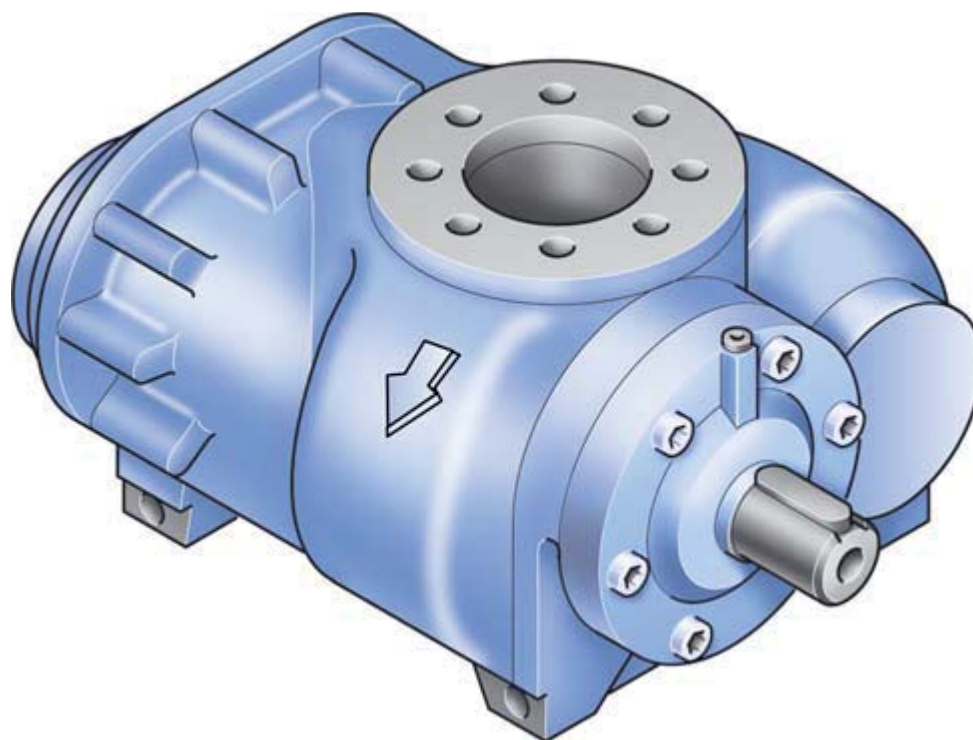



Operating range	
Power range up to	132* kW
Capacity up to	25 m ³ /min
Pressure up to	15 bar g
Weight approx.	250 kg

*Higher shaft power on request.

B 260

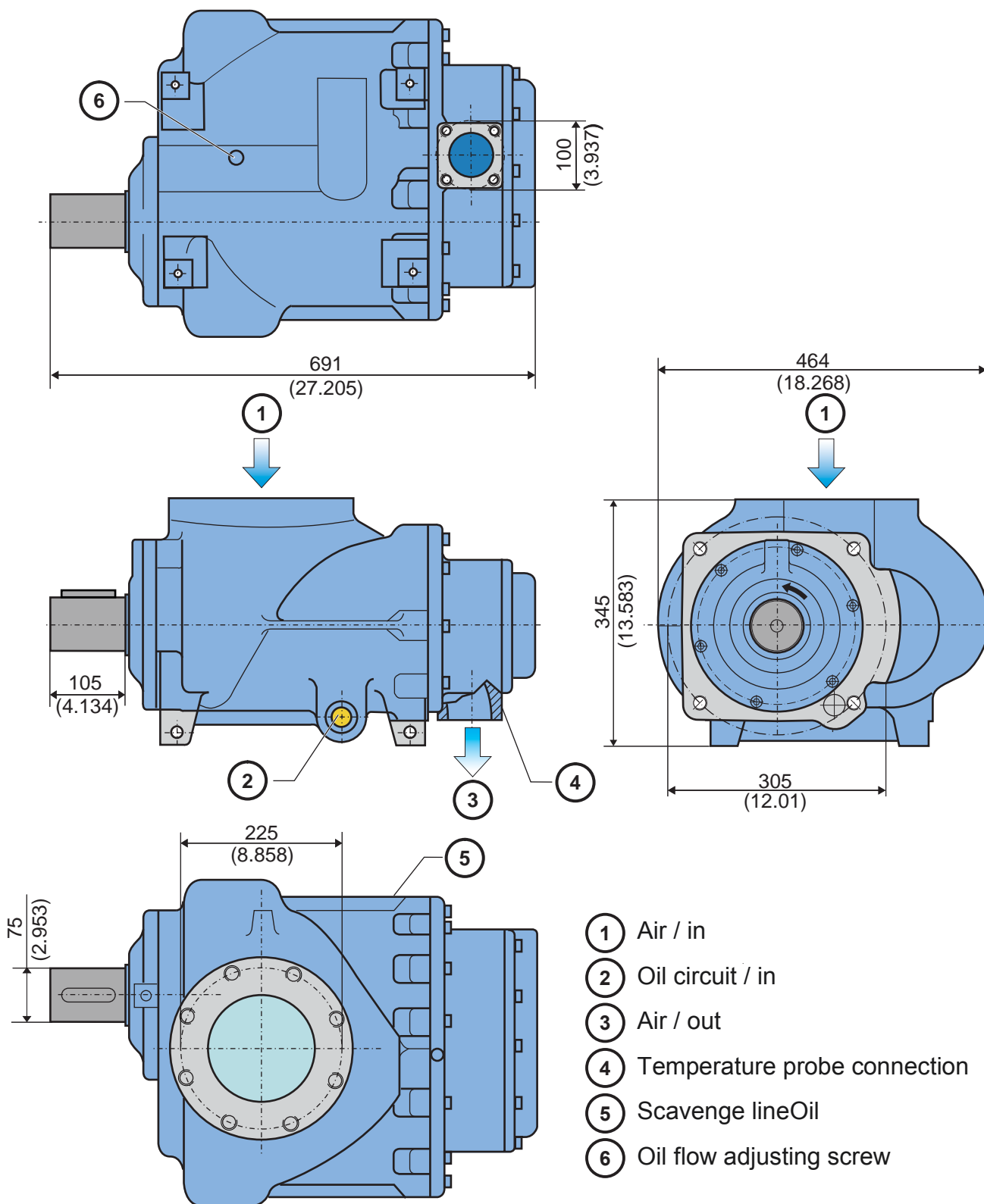
Dimensional details



 For detailed designing please order the installation drawing.

Dimensions in mm (inch)

B 260

Performance data

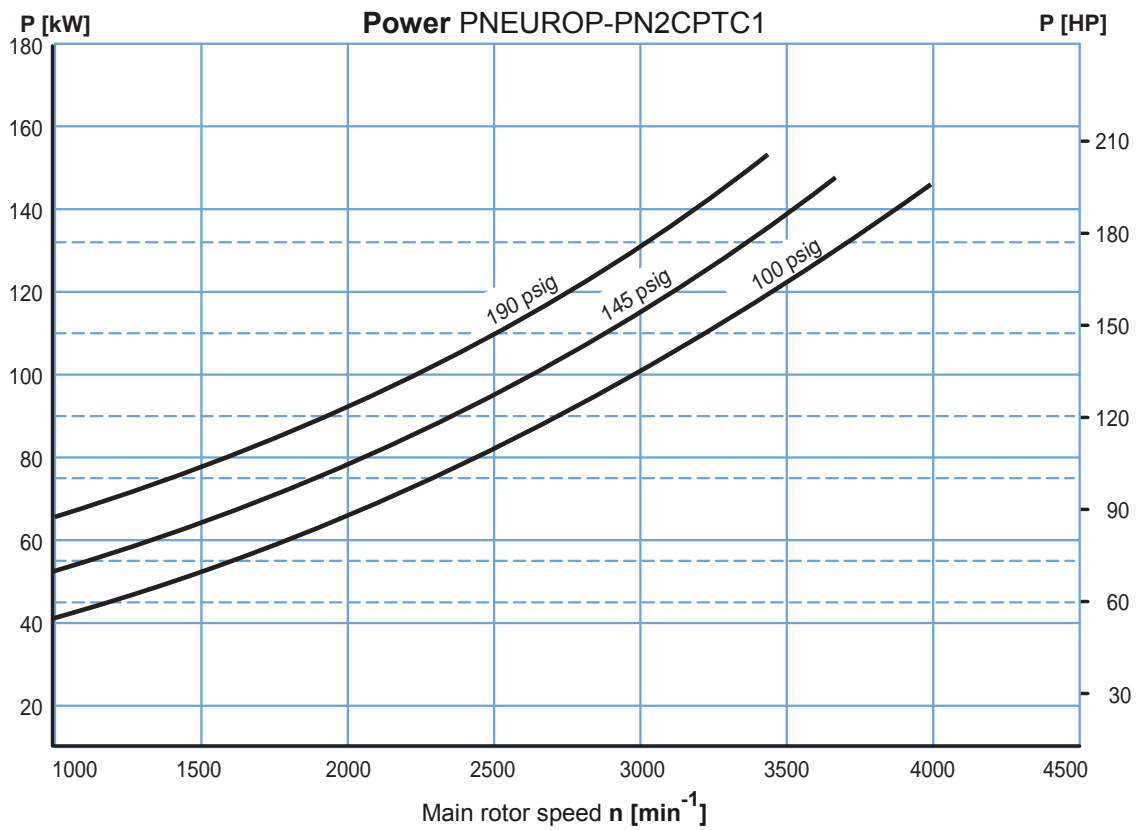
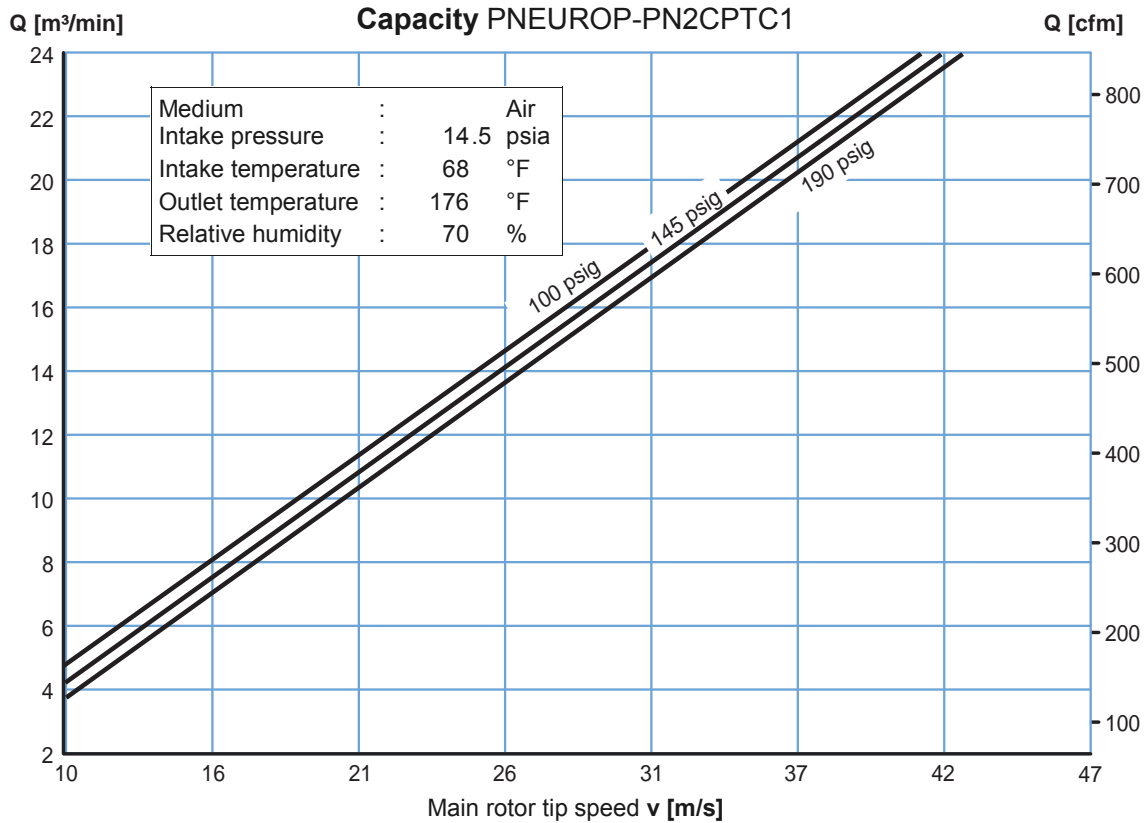

B 260

Components

Recommended original ROTORCOMP-equipment

	<p>Safety Combistat</p>		<p>Control units</p>
	<p>Fan (A) (Rotation direction /right) (Rotation direction / left) Oil cooler / Air after cooler (B)</p>		<p>Oil thermostats / Oil filters</p>
	<p>Intake filters Intake controls</p>		<p>Maintenance indicator (for intake filter) (A)= optical (B)= electrical</p>
	<p>Safety pressure switches</p>		<p>Glycerine pressure gauge</p>
	<p>Separator cartridges / Separator heads</p>		<p>Special tools</p>